

# Panasonic®



- SDXC Logo is a trademark of SD-3C, LLC.
- QuickTime and the QuickTime logo are trademarks or registered trademarks of Apple Inc., used under license therefrom.
- Other names, company names, and product names printed in these instructions are trademarks or registered trademarks of the companies concerned.

## Basic Operating Instructions

Digital Camera

Model No. **DMC-FP3**

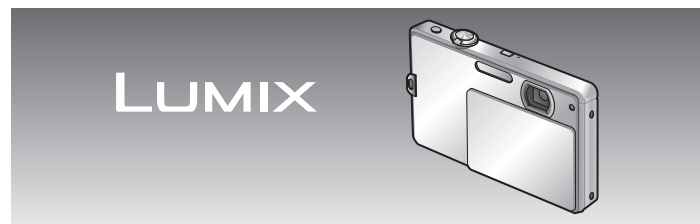

Before connecting, operating or adjusting this product, please read the instructions completely.

-If you see this symbol-



### Information on Disposal in other Countries outside the European Union

This symbol is only valid in the European Union. If you wish to discard this product, please contact your local authorities or dealer and ask for the correct method of disposal.

Please also refer to Operating Instructions (PDF format) recorded on the CD-ROM containing the Operating Instructions (supplied).



You can learn about advanced operation methods and check the Troubleshooting.

**Panasonic Consumer Electronics Company,  
Division of Panasonic Corporation of North America**

One Panasonic Way, Secaucus, NJ 07094

© Panasonic Corporation 2010

Printed in China

For USA and Puerto Rico assistance, please call: 1-800-211-PANA(7262) or, contact us via the web at: <http://www.panasonic.com/contactinfo>

P

VQT2L40-1  
M0110KZ1020

**Dear Customer,**

**Thank you for choosing Panasonic!**

You have purchased one of the most sophisticated and reliable products on the market today. Used properly, we're sure it will bring you and your family years of enjoyment. Please take the time to fill in the information below.

The serial number is on the tag located on the underside of your Camera.

Be sure to **retain this manual** as your convenient Camera information source. Please note that the actual controls and components, menu items, etc. of your Digital Camera may look somewhat different from those shown in the illustrations in these Operating Instructions.

### Carefully observe copyright laws.

- Recording of pre-recorded tapes or discs or other published or broadcast material for purposes other than your own private use may infringe copyright laws. Even for the purpose of private use, recording of certain material may be restricted.

Model No. \_\_\_\_\_ Serial No. \_\_\_\_\_



A lithium ion battery that is recyclable powers the product you have purchased. Please call 1-800-8-BATTERY for information on how to recycle this battery.

### Information for Your Safety

THE SOCKET OUTLET SHALL BE INSTALLED NEAR THE EQUIPMENT AND SHALL BE EASILY ACCESSIBLE.

### WARNING:

TO REDUCE THE RISK OF FIRE, ELECTRIC SHOCK OR PRODUCT DAMAGE,

- DO NOT EXPOSE THIS APPARATUS TO RAIN, MOISTURE, DRIPPING OR SPLASHING AND THAT NO OBJECTS FILLED WITH LIQUIDS, SUCH AS VASES, SHALL BE PLACED ON THE APPARATUS.
- USE ONLY THE RECOMMENDED ACCESSORIES.
- DO NOT REMOVE THE COVER (OR BACK); THERE ARE NO USER SERVICEABLE PARTS INSIDE. REFER SERVICING TO QUALIFIED SERVICE PERSONNEL.

Product Identification Marking is located on the bottom of units.

### ■ About the battery pack

#### CAUTION

Battery pack (Lithium ion battery pack)

- Use the specified unit to recharge the battery pack.
- Do not use the battery pack with equipment other than the specified unit.
- Do not get dirt, sand, liquids, or other foreign matter on the terminals.
- Do not touch the plug terminals (+ and -) with metal objects.
- Do not disassemble, remodel, heat or throw into fire.

If any electrolyte should come into contact with your hands or clothes, wash it off thoroughly with water.

If any electrolyte should come into contact with your eyes, never rub the eyes. Rinse eyes thoroughly with water, and then consult a doctor.

#### CAUTION

Danger of explosion if battery is incorrectly replaced. Replace only with the same or equivalent type recommended by the manufacturer. Dispose of used batteries according to the manufacturer's instructions.

- Do not heat or expose to flame.
- Do not leave the battery(ies) in an automobile exposed to direct sunlight for a long period of time with doors and windows closed.

#### Warning

Risk of fire, explosion and burns. Do not disassemble, heat above 60 °C (140 °F) or incinerate.

#### FCC Note:

This equipment has been tested and found to comply with the limits for a Class B digital device, pursuant to Part 15 of the FCC Rules. These limits are designed to provide reasonable protection against harmful interference in a residential installation. This equipment generates, uses, and can radiate radio frequency energy and, if not installed and used in accordance with the instructions, may cause harmful interference to radio communications. However, there is no guarantee that interference will not occur in a particular installation. If this equipment does cause harmful interference to radio or television reception, which can be determined by turning the equipment off and on, the user is encouraged to try to correct the interference by one or more of the following measures:

- Reorient or relocate the receiving antenna.
- Increase the separation between the equipment and receiver.
- Connect the equipment into an outlet on a circuit different from that to which the receiver is connected.
- Consult the dealer or an experienced radio/TV technician for help.

FCC Caution: To assure continued compliance, follow the attached installation instructions and use only shielded interface cables with ferrite core when connecting to computer or peripheral devices.

Any changes or modifications not expressly approved by the party responsible for compliance could void the user's authority to operate this equipment.

#### Declaration of Conformity

**Trade Name:** Panasonic

**Model No.:** DMC-FP3

**Responsible party:** Panasonic Corporation of North America  
One Panasonic Way,  
Secaucus, NJ 07094

**Support Contact:** Panasonic Consumer Electronics Company  
1-800-211-PANA (7262)

This device complies with Part 15 of the FCC Rules. Operation is subject to the following two conditions: (1) This device may not cause harmful interference, and (2) this device must accept any interference received, including interference that may cause undesired operation.



#### ■ About the battery charger

##### CAUTION!

**DO NOT INSTALL OR PLACE THIS UNIT IN A BOOKCASE, BUILT-IN CABINET OR IN ANOTHER CONFINED SPACE. ENSURE THE UNIT IS WELL VENTILATED. TO PREVENT RISK OF ELECTRIC SHOCK OR FIRE HAZARD DUE TO OVERHEATING, ENSURE THAT CURTAINS AND ANY OTHER MATERIALS DO NOT OBSTRUCT THE VENTILATION VENTS.**

#### Battery charger

This battery charger operates on AC between 110 V and 240 V.

But

- In the U.S.A. and Canada, the battery charger must be connected to a 120 V AC power supply only.
- When connecting to an AC supply outside of the U.S.A. or Canada, use a plug adaptor to suit the AC outlet configuration.

#### ■ Cautions for Use

- Do not use any other AV cables except the supplied one.
- Do not use any other USB connection cables except the supplied one.

#### Keep the camera as far away as possible from electromagnetic equipment (such as microwave ovens, TVs, video games etc.).

- If you use the camera on top of or near a TV, the pictures and sound on the camera may be disrupted by electromagnetic wave radiation.
- Do not use the camera near cell phones because doing so may result in noise adversely affecting the pictures and sound.
- Recorded data may be damaged, or pictures may be distorted, by strong magnetic fields created by speakers or large motors.
- Electromagnetic wave radiation generated by microprocessors may adversely affect the camera, disturbing the pictures and sound.
- If the camera is adversely affected by electromagnetic equipment and stops functioning properly, turn the camera off and remove the battery or disconnect AC adaptor (DMW-AC5PP; optional). Then reinsert the battery or reconnect AC adaptor and turn the camera on.

#### Do not use the camera near radio transmitters or high-voltage lines.

- If you record near radio transmitters or high-voltage lines, the recorded pictures and sound may be adversely affected.

# Contents

## Information for Your Safety .....2

### Before use

## Standard accessories .....7

## Names of parts .....8

Touch operations .....9

### Preparations

## Charging battery .....10

## Inserting and removing the card

## (optional)/the battery .....12

Picture save destination  
(cards and built-in memory) .....13

## Setting the clock .....14

## Setting the menu .....15

### Basics

## Taking pictures with automatic settings

## [INTELLIGENT AUTO] Mode ....16

## Selecting the [REC] mode .....18

## Taking motion pictures

## [MOTION PICTURE] Mode .....19

## Viewing your pictures

## [NORMAL PLAY] .....20

## Deleting pictures .....20

### Others

## Reading the Operating

## Instructions (PDF format) .....21

## Specifications .....23

## Optional accessories .....26

## Digital Camera Accessory

## Order Form .....27

## Limited Warranty (ONLY FOR U.S.A. AND PUERTO RICO) .....28

# Standard accessories

Check that all the accessories are included before using the camera. Part numbers are as of January 2010.

### Battery Pack

- DMW-BCH7PP  
• Charge the battery before use.



Battery Pack is indicated as battery pack or battery in the text.

### Battery Charger

DE-A75B



Battery Charger is indicated as battery charger or charger in the text.

### Battery Carrying Case

VGQ0J54



### Hand Strap

VFC4297



### USB Connection Cable

K1HA08AD0002



### AV Cable

K1HA08CD0028



### CD-ROM

VFF0571

- Software:  
Use it to install the software on your PC.
- Operating Instructions



- Cards are optional. You can record or play back pictures on the built-in memory when you are not using a card.
- If any accessories are lost, customers should contact Panasonic's parts department at 1 800 833-9626 for further information about obtaining replacement parts.
- Please dispose of all packaging appropriately.

# Names of parts

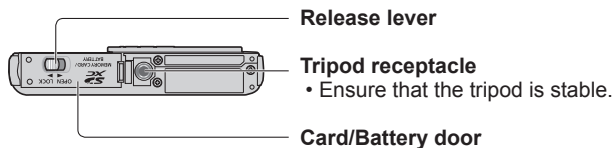
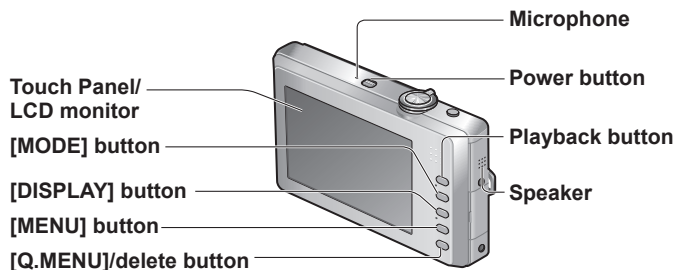
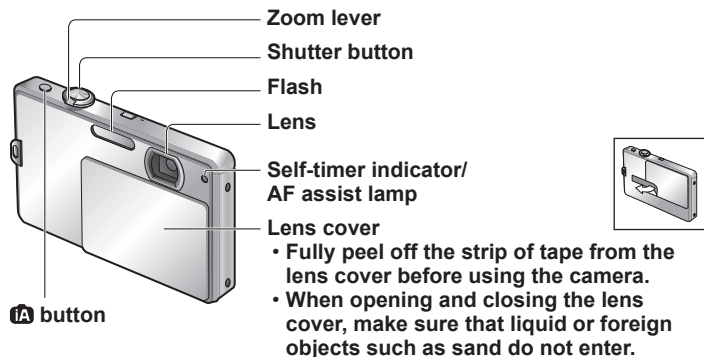

- We recommend you use a battery with sufficient battery power or the AC adaptor when recording motion pictures.

The illustrations and screens in this manual may differ from the actual product.

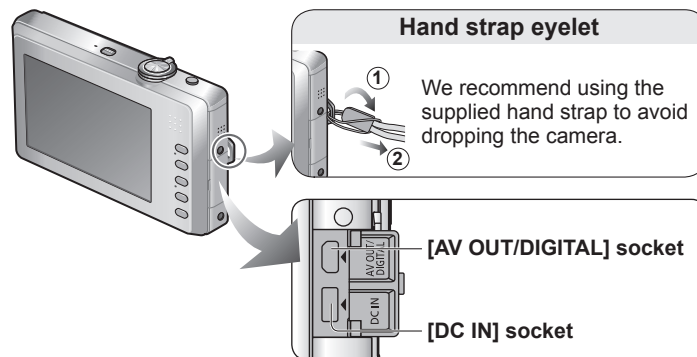

- Always use a genuine Panasonic AC adaptor (DMW-AC5PP: optional).
- If while recording motion pictures using the AC adaptor the power supply is cut off due to a power cut or if the AC adaptor is disconnected etc., the motion picture being recorded will not be recorded.

## Touch operations

### ■ Touch

To "touch" is to press the touch panel and then pull the finger back again.



### ■ Drag

To "drag" is to touch and slide your finger across the touch panel surface.



### ■ Effective range of touching

Touch operations do not work at the edge of the screen.



Detection area of the sensor (approximation)

- During touch operations, hold the camera securely so it does not drop.

## Charging battery

### ■ About batteries that you can use with this unit

The battery that can be used with this unit is DMW-BCH7PP.

It has been found that counterfeit battery packs which look very similar to the genuine product are made available to purchase in some markets. Some of these battery packs are not adequately protected with internal protection to meet the requirements of appropriate safety standards. There is a possibility that these battery packs may lead to fire or explosion. Please be advised that we are not liable for any accident or failure occurring as a result of use of a counterfeit battery pack. To ensure that safe products are used we would recommend that a genuine Panasonic battery pack is used.

- Use the dedicated charger and battery.
- The camera has a function for distinguishing batteries which can be used safely. The dedicated battery (DMW-BCH7PP) supports this function. The only batteries suitable for use with this unit are genuine Panasonic products and batteries manufactured by other companies and certified by Panasonic. (Batteries which do not support this function cannot be used). Panasonic cannot in any way guarantee the quality, performance or safety of batteries which have been manufactured by other companies and are not genuine Panasonic products.
- The battery is not charged when the camera is shipped. Charge the battery and set the clock before use.
- Charge the battery with the charger indoors (10 °C - 35 °C) (50 °F - 95 °F).

### 1 Insert the battery terminals and attach the battery to the charger

Ensure [LUMIX] faces outwards.



### 2 Connect the charger to the electrical outlet

#### Charging light ([CHARGE])

**On:** Charging in progress (approx. 110 min. if fully depleted)

**Off:** Charging complete

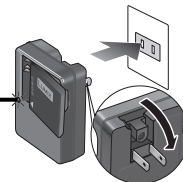

### 3 Detach the battery after charging is completed

#### ■ Guidelines for number of recordable pictures and recording time

Number of recordable pictures	Approx. 300 pictures
Recording time	Approx. 150 min
Playback time	Approx. 260 min

#### Recording conditions by CIPA standard

- CIPA is an abbreviation of [Camera & Imaging Products Association].
- [NORMAL PICTURE] Mode
- Temperature: 23 °C (73.4 °F)/Humidity: 50% when LCD monitor is on.\*
- Using a Panasonic SD Memory Card (32 MB).
- Using the supplied battery.
- Starting recording 30 seconds after the camera is turned on. (When the optical image stabilizer function is set to [AUTO].)
- Recording once every 30 seconds with full flash every second recording.
- Rotating the zoom lever from Tele to Wide or vice versa in every recording.
- Turning the camera off every 10 recordings and leaving it until the temperature of the battery decreases.

\* The number of recordable pictures decreases in Auto Power LCD Mode and Power LCD Mode.

# Inserting and removing the card (optional)/the battery

**1** Turn the camera off and slide the release lever (A) to [OPEN] before opening the lid

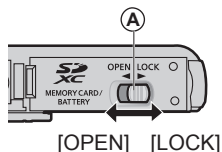

**2** Completely insert battery and card

- (B) Battery: Insert until the lever locks into place.
- (C) Card: Insert until it clicks / Do not touch terminal
- (D) Check orientation

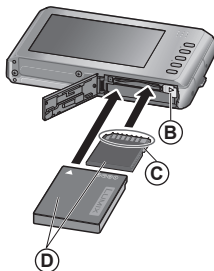

**3** Close lid  
Slide to the [LOCK] position.

## ■ To remove

- To remove battery: move lever in direction of arrow.



- To remove card: press down in center.

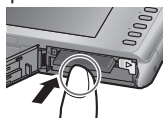

- Always use genuine Panasonic batteries (DMW-BCH7PP).
- If you use other batteries, we cannot guarantee the quality of this product.
- The card may be damaged if it is not fully inserted.

## Picture save destination (cards and built-in memory)

### ■ Built-in memory (approx. 40 MB)

- The built-in memory can be used as a temporary storage device when the card being used becomes full.
- The access time for the built-in memory may be longer than the access time for a card.

### ■ Compatible memory cards (optional)

The following SD standard-based cards (Panasonic brand recommended)

Type of Card	Capacity	Notes
SD memory cards	8 MB – 2 GB	<ul style="list-style-type: none"> <li>• Can be used with devices compatible with the respective formats.</li> <li>• Before using SDXC memory cards, check that your computer and other devices support this type of card. <a href="http://panasonic.net/avc/sdcard/information/SDXC.html">http://panasonic.net/avc/sdcard/information/SDXC.html</a></li> <li>• Cards in capacities not listed at left are not supported.</li> </ul>
SDHC memory cards	4 GB – 32 GB	
SDXC memory cards	48 GB – 64 GB	

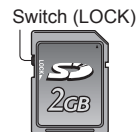

- If the write-protect switch is set to 'LOCK', the card cannot be used to record or delete pictures, and it cannot be formatted.
- Latest information: <http://panasonic.jp/support/global/cs/dsc/> (This Site is English only.)

- Keep the Memory Card out of reach of children to prevent swallowing.

## Setting the clock

The clock is not set when the camera is shipped.

### 1 Open the lens cover (A)

The power is turned on.

### 2 Touch [CLOCK SET]

### 3 Touch ▲▼◀▶ on the screen to set date and time and display format

• To cancel → Touch [CANCEL]

### 4 Touch [SET]

### 5 Touch [SET]

- To return to the previous screen → Touch [CANCEL]
- Turn on power again and check time display.

### ■ To change time setting

Touch [CLOCK SET] from the  [REC] or  [SETUP] menu, and then complete steps 3 and 4.

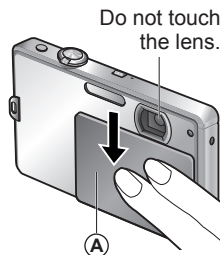

## Setting the menu

Refer to the procedure below when operating the [SETUP] menu, [REC] menu and [PLAYBACK] menu.

### 1 Open the lens cover

The power is turned on.

### 2 Press MENU to display the menu screen

### 3 Touch the type of menu to switch between them

Menu type

 : [REC] menu (Recording Mode only)

 : [PLAYBACK] menu (Playback Mode only)

 : [SETUP] menu



### 4 Touch a menu item

- Touch [EXIT] to return to the original screen.



item

### 5 Touch the settings you wish to change

- The procedure for making settings varies by menu.



settings

### 6 Touch [EXIT]

- Also if the shutter button is pressed halfway during an operation, the display will return to the original screen.



# Taking pictures with automatic settings

[INTELLIGENT AUTO] Mode

Recording Mode: **iA**

Optimum settings are made automatically from information such as 'face,' 'movement,' 'brightness,' and 'distance' just by pointing the camera at the subject, meaning that clear pictures can be taken without the need to make settings manually.

## 1 Open the lens cover

The power is turned on.

## 2 Press **iA** (A)

## 3 Take pictures



Press halfway  
(press lightly and focus)



Press fully  
(press the button all the way to record)

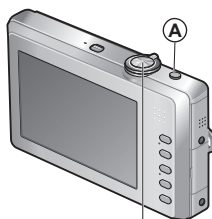

Shutter button

- If jitter becomes noticeable, use both hands, keep your arms close to your body, and stand with your feet at shoulder width.
- **Focus display (B)**  
(In focus: lit / Not in focus: flashing)
- The AF area (C) is displayed around the subject's face by the Face Detection function. In other cases, it is displayed at the point on the subject which is in focus.
- Focus: Max. W: 10 cm (0.33 feet)/ Max. T: 50 cm (1.64 feet) and above



## Automatic scene detection

Camera identifies scene when pointed at subject, and makes optimum settings automatically. The type of scene detected is indicated by a blue icon for two seconds.

[i PORTRAIT]: People are detected	[i NIGHT PORTRAIT]: People and night scenery are detected (Only when <b>iA</b> is selected)
[i SCENERY]: Scenery is detected	[i NIGHT SCENERY]: Night scenery is detected
[i MACRO]: A close-up shot is detected	[i SUNSET]: A sunset is detected
<b>iA</b> Reads subject movement to avoid blurring when scene does not correspond to any of the above.	

If the camera automatically identifies the scene and determines that people appear as subjects in the picture ( or ) , Face Detection is activated, and the focus and exposure are adjusted for the recognized faces.

## Selecting the [REC] mode

### 1 Open the lens cover

The power is turned on.

### 2 Press the [MODE] button (A)

### 3 Touch the desired Recording Mode

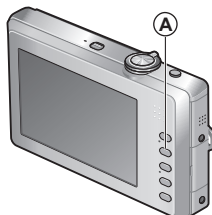
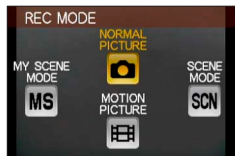

#### [NORMAL PICTURE] Mode

Take pictures with your own settings.

#### MS [MY SCENE MODE]

MS Take pictures in commonly used Scene Modes.

#### SCN [SCENE MODE]

SCN Take pictures according to scene.

#### [MOTION PICTURE] Mode

Take motion pictures.

## Taking motion pictures [MOTION PICTURE] Mode

Recording Mode: 

Record motion picture with audio as follows. (Note that recording without audio is not possible.)

### 1 Press the [MODE] button

### 2 Touch [MOTION PICTURE] Mode

### 3 Start recording



Hold down halfway  
(adjust the focus)



Press fully  
(start recording)

### 4 End recording



Press fully

Remaining recording  
time (approx.)



Elapsed recording time  
(approx.)

- The focus and zoom will remain as they were at the beginning of recording.
- Immediately release the shutter button after pressing it all the way.
- When there is no space left to store the motion picture, recording automatically ends.
- Motion pictures can be recorded continuously up to 2GB. To record more than 2 GB, press the shutter button again. (Remaining time for continuous recording is displayed on the screen.)

## Viewing your pictures [NORMAL PLAY]

Playback Mode:

1 Press (A)

2 Scroll through pictures (B)

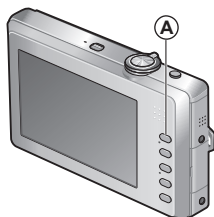

- You can also go to the next or previous picture by dragging the center of the screen.
- To play back a motion picture, use to select the picture and touch .

## Deleting pictures

Playback Mode:

Deleted pictures cannot be recovered.

1 Press Q.MENU to delete displayed picture (A)

2 Touch [DELETE SINGLE]

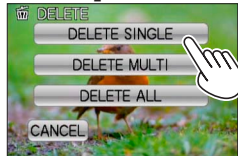

3 Touch [YES]

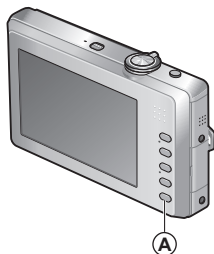

## Reading the Operating Instructions

(PDF format)

- You have practised the basic operations introduced in these operating instructions and want to progress to advanced operations.
- You want to check the Troubleshooting.

In these kinds of situations refer to Operating Instructions (PDF format) recorded on the CD-ROM containing the Operating Instructions (supplied).

### ■ For Windows

1 Turn the PC on and insert the CD-ROM containing the Operating Instructions (supplied)

2 Click the [Operating Instructions]

3 Select the desired language and then click [Operating Instructions] to install

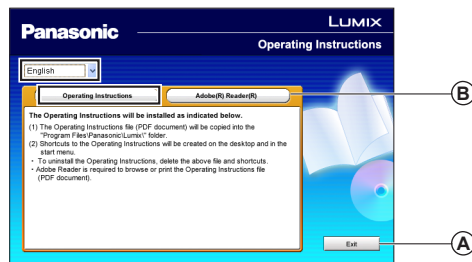

(A) To return to the install menu.

(B) See next page.

4 Double click the 'Operating Instructions' shortcut icon on the desktop

## Reading the Operating Instructions

(PDF format) (Continued)

### ■When the Operating Instructions (PDF format) will not open

You will need Adobe Acrobat Reader 5.0 or later or Adobe Reader 7.0 or later to browse or print the Operating Instructions (PDF format). Insert the CD-ROM containing the Operating Instructions (supplied), click (E) and then follow the messages on the screen to install.

Compatible OS: Windows 2000 SP4/Windows XP SP2 or SP3/Windows Vista SP1 or SP2/Windows 7

- You can download and install a version of Adobe Reader that you can use with your OS from the following Web Site.

<http://get.adobe.com/reader/otherversions>

### ■To uninstall the Operating Instructions (PDF format)

Delete the PDF file from the 'Program Files\Panasonic\Lumix\' folder.

- When the contents in the Program Files folder cannot be displayed, click the [Show the contents of this folder] to display them.

### ■For Macintosh

**1** Turn the PC on and insert the CD-ROM containing the Operating Instructions (supplied)

**2** Open the 'Manual' folder in the CD-ROM and then copy the PDF file with the desired language inside the folder

**3** Double click the PDF file to open it

## Specifications

Digital Camera: Information for your safety

<b>Power Source</b>	DC 5.1 V
<b>Power Consumption</b>	When recording: 1.0 W When playing back: 0.6 W
<b>Camera effective pixels</b>	14,100,000 pixels
<b>Image sensor</b>	1/2.33" CCD, total pixel number 14,500,000 pixels Primary color filter
<b>Lens</b>	Optical 4 x zoom f=6.3 mm to 25.2 mm (35 mm film camera equivalent: 35 mm to 140 mm) / F3.5 to F5.9
<b>Digital Zoom</b>	Max. 4 x
<b>Extended Optical Zoom</b>	Max. 8.4 x
<b>Focus range</b>	
<b>Normal</b>	50 cm (1.64 feet) to ∞
<b>Macro / Intelligent Auto</b>	10 cm (0.33 feet) (Wide) / 50 cm (1.64 feet) (Tele) to ∞
<b>Scene Mode</b>	There may be difference in above settings.
<b>Shutter system</b>	Electronic shutter + Mechanical shutter
<b>Burst recording</b>	
<b>Burst speed</b>	1.5 pictures/second
<b>Number of recordable pictures</b>	Until card/built-in memory is full
<b>Hi-speed burst</b>	
<b>Burst speed</b>	Approx. 4.6 pictures/second
<b>Number of recordable pictures</b>	Approx. 15 pictures (When using the built-in memory, immediately after formatting) Max. 100 pictures (When using a card, it may differ depending on the type of card and the recording conditions)

## Specifications (Continued)

<b>Shutter speed</b>	8 to 1/1600 th [STARRY SKY] mode: 15 seconds, 30 seconds, 60 seconds
<b>Exposure (AE)</b>	AUTO (Program AE) Exposure compensation (1/3 EV Step, -2 EV to +2 EV)
<b>Metering mode</b>	Multiple
<b>LCD monitor</b>	3.0" TFT LCD (Approx. 230,400 dots) (field of view ratio about 100 %)
<b>Flash</b>	Flash range: (ISO  ISO ) Approx. 30 cm (0.99 feet) to 4.9 m (16.08 feet) (Wide)
<b>Microphone</b>	Monaural
<b>Speaker</b>	Monaural
<b>Recording media</b>	Built-in Memory (Approx. 40 MB) / SD Memory Card / SDHC Memory Card / SDXC Memory Card
<b>Recording file format</b>	
<b>Still picture</b>	JPEG (based on Design rule for Camera File system, based on Exif 2.21 standard) / DPOF corresponding
<b>Motion pictures</b>	QuickTime Motion JPEG (motion pictures with audio)
<b>Interface</b>	Digital: USB 2.0 (Full Speed) Analog video / audio: NTSC Composit, Audio line output (Monaural)

<b>Terminal</b>	AV OUT / DIGITAL: Dedicated jack (8 pin) DC IN: Dedicated jack (2 pin)
<b>Dimensions</b>	Approx. 98.6 mm (W) x 58.9 mm (H) x 18.6 mm (D) [3.88" (W) x 2.32" (H) x 0.73" (D)] (excluding the projection part)
<b>Mass</b>	With card and battery: Approx. 145 g (0.32 lb) Excluding card and battery: Approx. 125 g (0.28 lb)
<b>Operating temperature</b>	0 °C to 40 °C (32 °F to 104 °F)
<b>Operating humidity</b>	10 % to 80 %
<b>Language select</b>	[ENGLISH]/[ESPAÑOL]

### Battery charger

(Panasonic DE-A75B): Information for your safety

<b>Input</b>	110 V to 240 V 50/60Hz, 0.2 A
<b>Output</b>	4.2 V $\equiv$ 0.65 A (Battery charging)

### Equipment mobility: Movable

#### Battery Pack (lithium-ion)

(Panasonic DMW-BCH7PP): Information for your safety

<b>Voltage/capacity</b>	3.7 V / 695 mAh
-------------------------	-----------------

## Optional accessories

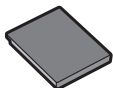

Product name: Battery Pack  
Product no.: DMW-BCH7PP

- Performance identical to supplied battery pack.
- Recommended for taking on holiday, etc.



Product name: AC adaptor  
Product no.: DMW-AC5PP



Product name: SDXC Memory Card  
Product no.: 48GB: RP-SDW48GU1K  
64GB: RP-SDW64GU1K

Product name: SDHC Memory Card  
Product no.: 4GB: RP-SDW04GU1K  
4GB: RP-SDP04GU1K  
4GB: RP-SDR04GU1A  
8GB: RP-SDW08GU1K  
8GB: RP-SDP08GU1K  
8GB: RP-SDR08GU1A  
16GB: RP-SDW16GU1K  
16GB: RP-SDP16GU1K  
32GB: RP-SDW32GU1K

Product name: SD Memory Card  
Product no.: 2 GB: RP-SDP02GU1K  
2 GB: RP-SDR02GU1A

- Product numbers are correct as of January 2010. These may be subject to change.
- Accessories and/or model numbers may vary between countries. Consult your local dealer.

## Digital Camera Accessory Order Form

Please photocopy this form when placing an order.

1. Digital Camera Model # \_\_\_\_\_
2. Items Ordered

Accessory #	Description	Price Each	Quantity	Total Price
			Subtotal	
			Your State & Local Sales Tax	
			Shipping & Handling	6.95
			Total Enclosed	

3. Method of payment (check one)

- Check of Money Order enclosed (NO C.O.D. SHIPMENTS)
- VISA Credit Card # \_\_\_\_\_
- MasterCard Expiration Date \_\_\_\_\_
- Discover Customer Signature \_\_\_\_\_

Make Check or Money Order to: PANASONIC ACCESSORIES

(Please do not send cash)

4. Shipping information (UPS delivery requires complete street address)

Ship To:

Mr.

Mrs.

Ms.

First \_\_\_\_\_ Last \_\_\_\_\_ Phone#: \_\_\_\_\_  
Day ( ) \_\_\_\_\_  
Street Address \_\_\_\_\_ Night ( ) \_\_\_\_\_  
City \_\_\_\_\_ State \_\_\_\_\_ Zip \_\_\_\_\_

TO OBTAIN ANY OF OUR DIGITAL CAMERA ACCESSORIES YOU CAN DO ANY OF THE FOLLOWING:  
VISIT YOUR LOCAL PANASONIC DEALER  
OR  
CALL PANASONIC'S ACCESSORY ORDER LINE AT 1-800-332-5368  
[6 AM-6 PM M-F, PACIFIC TIME]  
OR  
MAIL THIS ORDER TO: PANASONIC SERVICE AND TECHNOLOGY COMPANY  
ACCESSORY ORDER OFFICE  
20421 84th Avenue South Kent, WA. 98032

# Limited Warranty (ONLY FOR U.S.A. AND PUERTO RICO)

Panasonic Consumer Electronics Company,  
Division of Panasonic Corporation of North America  
One Panasonic Way, Secaucus, New Jersey 07094

## Panasonic Digital Still Camera Products Limited Warranty

### Limited Warranty Coverage (For USA and Puerto Rico Only)

If your product does not work properly because of a defect in materials or workmanship, Panasonic Consumer Electronics Company (referred to as “the warrantor”) will, for the length of the period indicated on the chart below, which starts with the date of original purchase (“warranty period”), at its option either (a) repair your product with new or refurbished parts, (b) replace it with a new or a refurbished equivalent value product, or (c) refund your purchase price. The decision to repair, replace or refund will be made by the warrantor.

Product or Part Name	Parts	Labor
Digital Still Camera	1 year	1 year
CCD	6 months	90 days
SD Memory Cards, Rechargeable Battery Pack (defective exchange)	90 days	Not Applicable

During the “Labor” warranty period there will be no charge for labor. During the “Parts” warranty period, there will be no charge for parts. This Limited Warranty excludes both parts and labor for non-rechargeable batteries, antennas, and cosmetic parts (cabinet). This warranty only applies to products purchased and serviced in the United States or Puerto Rico. This warranty is extended only to the original purchaser of a new product which was not sold “as is”.

### Mail-In Service

For assistance in the U.S.A. and Puerto Rico in obtaining repairs, please ship the product prepaid to:

**Panasonic Exchange Center**  
4900 George McVay Drive  
Suite B  
McAllen, TX 78503  
[panacare@us.panasonic.com](mailto:panacare@us.panasonic.com)

When shipping the unit, carefully pack, include all accessories, and send it prepaid, adequately insured and preferably in the original carton. If Lithium Ion batteries are shipped by air the package must be labeled “Contains Lithium Ion Battery (No lithium metal)”. Damaged batteries are prohibited from shipment by US Mail. Batteries must be securely packed in a manner to prevent short-circuiting and a package cannot contain more than 3 Lithium Ion batteries. Include a letter detailing the complaint, a return address and provide a daytime phone number where you can be reached. A valid registered receipt is required under the Limited Warranty.

**IF REPAIR IS NEEDED DURING THE WARRANTY PERIOD, THE PURCHASER WILL BE REQUIRED TO FURNISH A SALES RECEIPT/PROOF OF PURCHASE INDICATING DATE OF PURCHASE, AMOUNT PAID AND PLACE OF PURCHASE. CUSTOMER WILL BE CHARGED FOR THE REPAIR OF ANY UNIT RECEIVED WITHOUT SUCH PROOF OF PURCHASE.**

### Limited Warranty Limits And Exclusions

This warranty ONLY COVERS failures due to defects in materials or workmanship, and DOES NOT COVER normal wear and tear or cosmetic damage. The warranty ALSO DOES NOT COVER damages which occurred in shipment, or failures which are caused by products not supplied by the warrantor, or failures which result from accidents, misuse, abuse, neglect, mishandling, misapplication, alteration, faulty installation, set-up adjustments, misadjustment of consumer controls, improper maintenance, power line surge, lightning damage, modification, introduction of sand, humidity or liquids, commercial use such as hotel, office, restaurant, or other business or rental use of the product, or service by anyone other than a Factory Service Center or other Authorized Servicer, or damage that is attributable to acts of God.

**THERE ARE NO EXPRESS WARRANTIES EXCEPT AS LISTED UNDER "LIMITED WARRANTY COVERAGE".**

**THE WARRANTOR IS NOT LIABLE FOR INCIDENTAL OR CONSEQUENTIAL DAMAGES RESULTING FROM THE USE OF THIS PRODUCT, OR ARISING OUT OF ANY BREACH OF THIS WARRANTY.**

(As examples, this excludes damages for lost time, travel to and from the servicer, loss of or damage to media or images, data or other memory or recorded content. The items listed are not exclusive, but for illustration only.)

**ALL EXPRESS AND IMPLIED WARRANTIES, INCLUDING THE WARRANTY OF MERCHANTABILITY, ARE LIMITED TO THE PERIOD OF THE LIMITED WARRANTY.**

Some states do not allow the exclusion or limitation of incidental or consequential damages, or limitations on how long an implied warranty lasts, so the exclusions may not apply to you.

This warranty gives you specific legal rights and you may also have other rights which vary from state to state. If a problem with this product develops during or after the warranty period, you may contact your dealer or Service Center. If the problem is not handled to your satisfaction, then write to the warrantor's Consumer Affairs Department at the addresses listed for the warrantor.

**PARTS AND SERVICE, WHICH ARE NOT COVERED BY THIS LIMITED WARRANTY, ARE YOUR RESPONSIBILITY.**

#### ***Customer Services Directory (United States and Puerto Rico)***

Obtain Product Information and Operating Assistance; locate your nearest Dealer or Service Center; purchase Parts and Accessories; or make Customer Service and Literature requests by visiting our Web Site at:

<http://www.panasonic.com/help>

or, contact us via the web at:

<http://www.panasonic.com/contactinfo>

You may also contact us directly at:

1-800-211-PANA (7262)

Monday-Friday 9am-9pm, Saturday-Sunday 10am-7pm EST

**For hearing or speech impaired TTY users, TTY: 1-877-833-8855**

#### ***Accessory Purchases (United States and Puerto Rico)***

Purchase Parts, Accessories and Instruction Books online for all Panasonic Products by visiting our Web Site at:

<http://www.pstc.panasonic.com>

Or, send your request by E-mail to:

[nppcparts@us.panasonic.com](mailto:nppcparts@us.panasonic.com)

You may also contact us directly at:

1-800-332-5368 (Phone) 1-800-237-9080 (Fax Only)

(Monday-Friday 9am-9pm EST)

Panasonic Service and Technology Company

20421 84th Avenue South, Kent, WA 98032

(We accept Visa, MasterCard, Discover Card, American Express, and Personal Checks)

**For hearing or speech impaired TTY users, TTY: 1-866-605-1277**

As of November 2009



MEMO

MEMO