

Operating Instructions (Household) Battery-Powered Toothbrush Model No. EW-DS32



Before operating this unit, please read these instructions completely and save them for future use.

**Thank you for choosing a Panasonic Battery-Powered Toothbrush.
Please read all instructions before use.**

Safety Precautions

Warning

- Keep out of the reach of toddlers and infants.
 - Failure to do so may result in accidents or accidental ingestion of the accessories or removable small parts.
- Terminate the usage when there is abnormality or failure.
 - Continued use of the toothbrush may cause fire, electric shock or other injuries.

Caution

- People who have severe periodontal disease should consult a doctor before use. Failure to do so may cause damage to teeth and gums.
- Do not use the brush in combination with toothpaste that contains a lot of abrasive.
- Do not force the bristles hard against the teeth or gums, or apply the bristles to one area for prolonged periods.
- Do not apply the solid part of the brush head or the main unit to teeth.
- If you have oral health problems such as teeth undergoing treatment, avoid using the brush on those parts as doing so may cause damage to teeth and gums.
- Never modify, disassemble, or repair the appliance yourself as doing so may cause unexpected accidents or trouble.
- Use a mild detergent for cleaning.
- Never use thinners, benzine, or alcohol to clean the toothbrush since it may cause malfunction or cracking/discolouration of the parts.
- Parents and guardians of young children should check to ensure that the child is using the appliance correctly and does not chew the brush.
 - Without proper instruction, children may hurt themselves, damage the brush, or cause the bristles to drop out. This may result in damage to the teeth and gums, or in bristles being swallowed.
- Do not disinfect using boiling water, pharmaceutical solutions, or a microwave oven.
 - Doing so may result in damage to the main unit or brush head and cause injury.
- Do not continuously aim the LED lamp into the eyes.
 - Doing so may cause dizziness.

Parts identification

- A** Main unit
- ① LED lamp
 - ② Power switch [0/1]
 - ③ Battery cover
- B** Brush head (x1)
- ④ Flat bristles
 - ⑤ LED lamp window
 - ⑥ Water drainage hole
- C** Cap

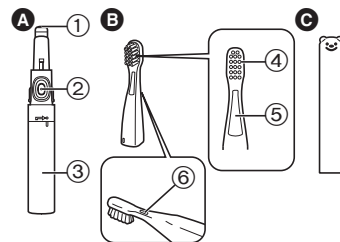

Attaching and removing the cap

Attach and remove the cap as illustrated.

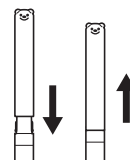

Attaching the brush head

Align the mark on the brush head with the mark on the main unit, and rotate it in the direction of the arrow until it clicks.

- Inserting the brush head without aligning the mark on the brush head with the mark on the main unit may damage the brush head or the main unit.



- Tightening it too much may cause deformation and damage to the main unit and the brush head.

Note

- When attaching the brush head, ensure that the LED lamp window and the power switch are on opposite sides.

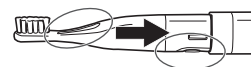

Removing the brush head

1. Rotate the brush head and align the marks.
2. Pull to remove the brush head.

- Pulling the brush head while it is fastened may damage the brush head or the main unit.
- When toothpaste gets hard and makes it difficult to remove the brush head, put it in water or warm water for a while and then remove.



If the brush head is hard to remove

If the brush head is hard to remove due to hardened toothpaste, soak the entire brush head in cold or lukewarm water for approximately 5 minutes and then remove.



Replacing the battery

The LED lamp will turn off and the vibration will gradually weaken. A few seconds later, operation will stop completely. Please replace the alkaline battery with a new one.

1. Remove the battery cover by rotating it.

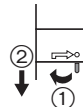

2. Insert LR03 (AAA alkaline battery).

- It is possible to use the appliance for approximately 60 days by using a Panasonic LR03 (AAA alkaline battery) (when used with the LED lamp turned on, once a day for 2 minutes).

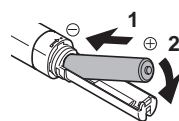

3. Attach the battery cover by rotating it.

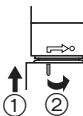

Caution

- Always follow the cautions printed on the battery.
- Check the polarities (+ and -) of the battery and install it correctly.
- Remove the battery when not using the appliance for an extended period of time.
- Please dispose of used battery appropriately.
- Do not disassemble the battery or throw it into a fire. Do not short-circuit the battery.

Notes

- Batteries are not supplied. Please purchase separately.
- Before replacing the alkaline battery, ensure the unit is thoroughly dry to prevent water drops entering the main unit.
- Always use alkaline batteries. Use of non-alkaline batteries may result in a drastically reduced operating time.
- Use only LR03 (AAA alkaline battery).

Using the toothbrush

1. Remove the cap.
2. Confirm that the brush head is fixed firmly.
3. Place the toothbrush in the mouth.
 - When using the toothbrush, especially with toothpaste applied, place the brush head in the mouth before operating to prevent splattering.
4. Press the power switch firmly to operate the toothbrush.
 - Each time you press the power switch, the appliance switches according to the following order: "Power ON/LED lamp ON", "Power ON/LED lamp OFF", "Power OFF/LED lamp OFF".
 - Press the power switch with the ball of the finger.
 - Do not press with a fingernail. Doing so may tear the rubber of the power switch.
5. Brush the teeth by moving the main unit by hand.
 - Brush by moving the toothbrush in the same way as when you brush by hand. Just applying the toothbrush to teeth cannot fully remove plaque, so it is recommended that you move the toothbrush. (See "Advice for brushing" and "Points to avoid pain in children".)
 - Do not apply the brush head to teeth or gums too strongly.
6. When finished brushing, stop the motion by pressing the power switch firmly.
 - In order to prevent splattering of saliva, etc., turn off the toothbrush while it is still in the mouth.
 - To prevent the power being left on after use, operation stops 5 minutes after the power is first switched on.

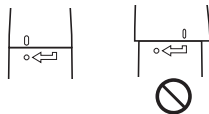

Caution

- Do not use for any purpose other than dental care.
- Do not drop or handle roughly.

Note

- Please be careful not to get hair products, hand cream, etc. on the main unit because it may ruin the appearance of the toothbrush.

Advice for brushing

How to hold the toothbrush

Hold the toothbrush lightly and do not use too much force. Brushing while pressing down hard may damage the teeth or gums. Holding the toothbrush lightly as shown in the Figure allows the best use of the bristle tips.

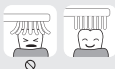
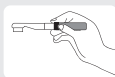

How to move the brush

Move horizontally, a little at a time.

Milk teeth are characterized by wide gaps between the teeth. Aim to use the tips of the bristles to clean the gaps between the milk teeth.

The fine motion of the brush will help the bristles reach difficult spots.



Check that no spot has been missed

Use the LED lamp to get a clear view.

Using the LED lamp allows a clear view of the inside of the mouth. It is easy to miss spots on the molars, but a clear view is now possible simply by applying the brush. Make sure that the brush is reaching its target as you brush.



Points to avoid pain in children

Finger technique is the key

If the child does not like brushing difficult spots, gently push down and pull up on the child's lips with your fingers so that you can brush smoothly.

Upper front teeth

With the fleshy part of the index finger of your other hand, gently lift the upper lip.

- Pulling the connective tissue, called the frenulum, above the front teeth may hurt, so be careful.



Outer side of molars

Have the child say "Eeee", then insert your finger from the edge of the lips to pull the cheek outward. If the child opens wide, the cheek will not stretch outwards and it will be difficult to insert the brush deep into the mouth.

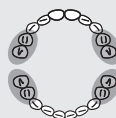

If the child is trying to close his or her mouth, this may indicate pain due to excessive force.

After use

Washing the brush head

- Wash the brush head under running water.
- Do not wash with water hotter than 80 °C (176 °F).
 - Do not pull the bristles of the brush. (Doing so may cause bristles to come out.)
 - Shake well to remove water after washing.



Washing the main unit

1. Make sure that the battery cover is closed.
 2. Wash the main unit under running water.
- Do not wash with water hotter than 40 °C (104 °F).
 - Do not immerse the main unit under water. (Otherwise water may get inside.)



Washing the cap

- Wash the Cap under running water.
- Do not wash with water hotter than 40 °C (104 °F).

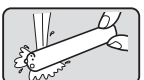

Caution

- Shake the cap and brush head well to drain off water, and dry them using a dry towel, etc. After this, put the cap on the main unit. Leaving them wet may dirty or damage the pouch or bag.

Changing the brush head (Sold separately)

- Replacing the brush head every 3 months is recommended. If the bristles are bent to one side or worn, the toothbrush is not effective for brushing.
- If the brush head is damaged by chewing, etc., there is a risk of damage to the teeth or gums. Please replace the brush head.

Part number	Replacement Brush for EW-DS32	Quantity
WEW0959		2

- Only Replacement Brush for EW-DS32 can be used.

Specifications

Model No.	EW-DS32
Power source	LR03 (AAA alkaline battery) x 1 (sold separately)

This product is intended for household use only.

FOR YOUR CONVENIENCE, WE HAVE ESTABLISHED A TOLL-FREE (IN USA ONLY) NATIONAL ACCESSORY PURCHASE HOT LINE AT 1-800-332-5368.

IN USA CONTACT:

Panasonic Corporation of North America
One Panasonic Way, Secaucus, NJ 07094

Service • Assistance • Accessories

Call 1-800-338-0552 (In USA)

<http://www.panasonic.com/shavers/>

<http://www.panasonic.com/consumersupport/>

Manufactured for
Panasonic Corporation
33, Okamachi, Hikone, Shiga, Japan