

# Panasonic®

## Installation Guide

### Home Network System Glass Break Sensor

Model No. **KX-HNS104**



#### Thank you for purchasing a Panasonic product.

This document explains how to install the glass break sensor properly. For details about how to use the system, refer to the User's Guide (page 17).

Please read this document before using the unit and save it for future reference.

For assistance, please contact us at 1-800-272-7033 or visit our Web site: <http://shop.panasonic.com/support> for customers in the U.S.A.

**Please register your product: <http://shop.panasonic.com/support>**

In order to use this device:

- Download the latest version of the **[Home Network]** app.
- Update your hub to the latest firmware version (version 5.55 or later).  
For more information, refer to the User's Guide (page 17).

Printed in China

## Table of Contents

---

### Introduction

Accessory information .....3

### Warnings and Product Limitations/Important Information

Disclaimer .....4  
About this system .....4  
For your safety .....4  
Important safety instructions .....5  
For best performance .....5  
Other information .....6

### Setup

Part names and functions .....8  
LED indicator .....8  
Setup overview .....8  
Inserting the batteries .....9  
Registering the sensor .....9  
Confirming the usage area .....10  
Information about sensor features .....12  
Wall mounting .....14

### Appendix

Adjusting the sensor sensitivity .....17  
Features available when using the [Home Network] app .....17  
Accessing the User's Guide ....17  
Specifications .....18  
FCC and other information .....19  
Customer services .....20  
Limited Warranty (ONLY FOR U.S.A.) .....21

## Accessory information

### Supplied accessories

No.	Accessory item/Part number	Quantity
①	Batteries*1	2
②	Wall mounting adaptor*2/PNKK1111Z1	1
③	Wall mounting screws (25 mm (1 inch))/XTB4+25AVW	2

\*1 When replacing batteries, see "Power source" of "Specifications", page 18 for battery information.

\*2 The sensor can be wall mounted with or without the wall mounting adaptor (page 14).



### Other information

- Design and specifications are subject to change without notice.
- The illustrations in these instructions may vary slightly from the actual product.

### Trademarks

- iPhone and iPad are registered trademarks of Apple Inc.
- Android is a trademark of Google Inc.
- Microsoft, Windows, and Internet Explorer are either registered trademarks or trademarks of Microsoft Corporation in the United States and/or other countries.
- All other trademarks identified herein are the property of their respective owners.

For assistance, please visit <http://shop.panasonic.com/support> 3

## Warnings and Product Limitations/Important Information

### Disclaimer

When properly installed and maintained, this product is designed to help provide an added layer of notice in the case of broken glass. Panasonic Corporation of North America makes no representations or warranties that it will at all times, or under all circumstances, or in any given circumstance, detect broken glass, or work with all types of glass, or that it will prevent loss of or damage to property or persons. Panasonic Corporation of North America shall have no liability for any personal injury, or damage to property or other loss, of any kind, should the product fail to warn or notify.

### About this system

- This system is an auxiliary system; it is not designed to provide complete protection from property loss. Panasonic will not be held responsible in the event that property loss occurs while this system is in operation.
- The system's wireless features are subject to interference, therefore functionality in all situations cannot be guaranteed. Panasonic will not be held responsible for injury or damage to property that occurs in the event of wireless communication error or failure.

### For your safety

To prevent severe injury and loss of life/property, read this section carefully before using the product to ensure proper and safe operation of your product.

#### WARNING

##### Power connection

- Use only the power source marked on the product.
- Do not connect non-specified devices.

##### Installation

- To prevent the risk of fire or electrical shock, do not expose the product to rain or any type of moisture.
- Do not place or use this product near automatically controlled devices such as automatic doors and fire alarms. Radio waves emitted from this product may cause such devices to malfunction resulting in an accident.
- Install the product only on a vertical surface. Do not install the product on a ceiling, as the product may fall, resulting in damage or injury.
- Keep small parts (screws, etc.) out of the reach of children. There is a risk of swallowing. In the event they are swallowed, seek medical advice immediately.

##### Operating safeguards

- Do not disassemble the product.

4 For assistance, please visit <http://shop.panasonic.com/support>

## Warnings and Product Limitations/Important Information

### Medical

- Consult the manufacturer of any personal medical devices, such as pacemakers or hearing aids, to determine if they are adequately shielded from external RF (radio frequency) energy. DECT features operate between 1.92 GHz and 1.93 GHz with a peak transmission power of 115 mW.
- Do not use the product in health care facilities if any regulations posted in the area instruct you not to do so. Hospitals or health care facilities may be using equipment that could be sensitive to external RF energy.

### CAUTION

### Battery

- The batteries should be used correctly, otherwise the product may be damaged due to battery leakage.
- Do not charge, short-circuit, disassemble, or heat the batteries.
- Do not dispose of batteries in a fire.
- Remove all the batteries when replacing.
- Do not mix old, new or different types of batteries.
- It is recommended that batteries are replaced annually.
- Keep out of the reach of small children. There is a risk of swallowing. If the battery is swallowed, seek medical attention immediately.
- Remove the battery if it becomes unusable. There is a risk of leakage, overheating, and rupture. Do not attempt to use a battery if it is leaking.

- Do not intentionally pour water on the battery or allow it to get wet. There is a risk of fire and smoke. If the battery becomes wet, remove it immediately and contact an authorized service center.

## Important safety instructions

When using your product, basic safety precautions should always be followed to reduce the risk of fire, electric shock, and injury to persons, including the following:

1. Do not use this product near water for example, near a bathtub, washbowl, kitchen sink, or laundry tub, in a wet basement or near a swimming pool.
2. Use only the batteries indicated in this document. Do not dispose of batteries in a fire. They may explode. Check with local codes for possible special disposal instructions.

### SAVE THESE INSTRUCTIONS

## For best performance

### Hub location/avoiding noise

The hub and other compatible Panasonic devices use radio waves to communicate with each other.

- For maximum coverage and noise-free communications, place your hub:
  - at a convenient, high, and central location with no obstructions

For assistance, please visit <http://shop.panasonic.com/support> 5

## Warnings and Product Limitations/Important Information

---

- between the product and hub in an indoor environment.
- away from electronic appliances such as TVs, radios, personal computers, wireless devices, or other phones.
- facing away from radio frequency transmitters, such as external antennas of mobile phone cell stations. (Avoid putting the hub on a bay window or near a window.)
- If the reception for a hub location is not satisfactory, move the hub to another location for better reception.

---

### Environment

- Keep the product away from electrical noise generating devices, such as fluorescent lamps and motors.
- The product should be kept free from excessive smoke, dust, high temperature, and vibration.
- The product should not be exposed to direct sunlight.
- Do not place heavy objects on top of the product.
- The product should be kept away from heat sources such as heaters, kitchen stoves, etc. It should not be placed in rooms where the temperature is less than 0 °C (32 °F) or greater than 40 °C (104 °F). Damp basements should also be avoided.
- Operating the product near electrical appliances may cause interference. Move away from the electrical appliances.
- The sensor may make false detections in noisy locations, such as where there is noise from metallic blinds opening and closing, or metallic bells of alarm clocks. Avoid

installing the sensor in these locations.

- The sounds of doors opening and closing may cause false detections. Do not install the sensor near doors.
- Do not place screens or shielding (such as sound blocking curtains) between the glass and sensor. This may prevent the sensor from being able to detect the sound of glass breaking.
- The product may not be able to detect the sound of glass breaking depending on the noise conditions of the surrounding area.
- To avoid false detections, do not install the product in areas where loud noises occur or near devices that produce loud noise.
- Refer to "Sensor detection range" on page 13 and install the product within the wireless communication range of the hub.

---

## Other information

**CAUTION:** Risk of explosion if battery is replaced by an incorrect type. Dispose of used batteries according to the instructions.

---

### Routine care

- Wipe the outer surface of the product with a soft moist cloth.
- Do not use benzine, thinner, or any abrasive powder.

---

6 For assistance, please visit <http://shop.panasonic.com/support>

## Warnings and Product Limitations/Important Information

### Information on Disposal in other Countries outside the European Union



These symbols are only valid in the European Union. If you wish to discard these items, please contact your local authorities or dealer and ask for the correct method of disposal.

### Note for the battery removal procedure

Refer to "Inserting the batteries" on page 9.

### Notice

- This product is designed for use in the United States of America. Sale or use of this product in other countries may violate local laws.
- Cet appareil est conçu pour être utilisé aux États-Unis d'Amérique. La vente ou l'emploi de cet appareil dans certains autres pays peut constituer une infraction à la législation locale.
- Este producto está diseñado para usarse en los Estados Unidos de América. La venta o el empleo de este producto en ciertos países puede constituir violación de la legislación local.
- 本產品專為美國使用而設。若在其他國家銷售或使用，可能會違反當地法例。
- この製品は、日本国外での使用を目的として設計されており、日本国内での使用は法律違反となります。従って、当社では日本国内においては原則として修理などのサービスは致しかねます。

For assistance, please visit <http://shop.panasonic.com/support> 7

## Setup

### Part names and functions

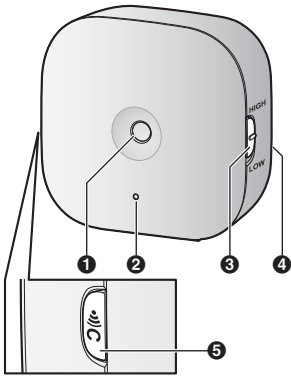

- ① **Microphone**
- ② **LED indicator**
- ③ **[HIGH]/[LOW]**  
Used to change the sensor sensitivity (page 17).
- ④ **Rear cover**
- ⑤ **[●]C**  
Used to confirm the status of the sensor or register the sensor to the hub.

### LED indicator

You can press [●]C and check the LED indicator to confirm the sensor's status. After confirming the sensor's status, we recommend turning the LED indicator off by pressing [●]C again as soon as possible, otherwise battery life may be reduced.

Indicator	Status
Green, lit	No glass break detected
Red, lit	Glass break was detected
Red, blinking	Sensor is out of range of the hub
Green, blinking slowly	Registration mode (You pressed and held [●]C)
Off	No battery power

#### Note:

- The LED indicator does not indicate sensor status if the sensor has not been registered (page 9).

### Setup overview

- 1 Initial setup**  
Make sure you can access the system using your mobile device. For details, refer to the System Setup Guide included with your hub.
- 2 Insert the batteries**  
The sensor is battery powered.
- 3 Registration**  
Required only if the sensor was purchased separately (i.e., not as part of a bundle).
- 4 Confirm the installation area**  
Read the information in this document to confirm that the desired installation area is suitable to proper operation.
- 5 Installation**  
Install the sensor in the desired location.

8 For assistance, please visit <http://shop.panasonic.com/support>



## Inserting the batteries

- USE ONLY Alkaline batteries AA (LR6) size.
  - Do NOT use Manganese/Ni-Cd/ Ni-MH batteries.
  - Confirm the polarities (+, -).
- 1 Remove the rear cover by pressing the upper sides of the cover (1) and sliding it down (2).

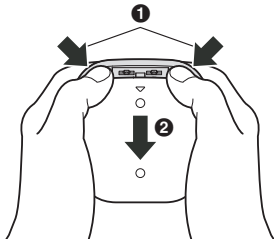

- 2 Insert the batteries.

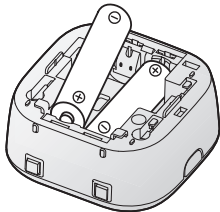

- 3 Install the rear cover.
  - Place it with the "▽" mark facing upwards and slide it.

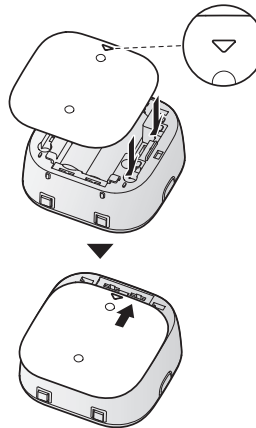

### Note:

- If the sensor's battery power is low, a message will be displayed on the [Sensor] screen of the [Home Network] app. We recommend you check this screen periodically to ensure that the battery does not become fully discharged. For more information, refer to the User's Guide (page 17).

## Registering the sensor

This procedure is not required for devices that were included as part of a bundle.

For assistance, please visit <http://shop.panasonic.com/support> 9

## Setup

Before you can use the sensor, it must be registered to the hub.

If you purchased devices separately (i.e., not as part of a bundle), you must register each device to the hub.

You can register each device by using the registration buttons or the **[Home Network]** app.

### Note:

- For information about deregistering devices, refer to the User's Guide (page 17).

## Using registration buttons

- 1 Hub:**  
Press and hold **[••]C OTHER DEVICE]** until the LED indicator blinks slowly in green.
- 2 Sensor:**  
Press and hold **[••]C]** until the LED indicator blinks slowly in green (page 8).
  - When registration is complete, the hub sounds one long beep.

### Note:

- To cancel without registering the sensor, press **[••]C]** on the hub and on the sensor again.
- If registration fails, the hub sounds several short beeps.

## Using the app

When you register the sensor by using the **[Home Network]** app, you can assign a name to your devices and group them by location. For more information, refer to the User's Guide (page 17).

## Confirming the usage area

### Wireless communication range

The wireless communication range of each device in the system from the hub is approximately 50 m (160 feet) indoors and approximately 300 m (1,000 feet) outdoors. Wireless communication may be unreliable when the following obstacles are located between the hub and other devices.

- Metal doors or screens
- Walls containing aluminum-sheet insulation
- Walls made of concrete or corrugated iron
- Double-pane glass windows
- Multiple walls
- When using each device on separate floors or in different buildings

### Note:

- You can check the sensor's communication status by pressing **[••]C]**. If the LED indicator is lit in green or red, the sensor is communicating properly with the hub. If the LED indicator blinks in red, it is out of range of the hub.

### Usage area cautions

Using the sensor in the following areas may cause deformation, malfunction, or operational failure.

- In direct sunlight
- Areas exposed to grease or steam, such as kitchens

10 For assistance, please visit <http://shop.panasonic.com/support>

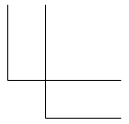
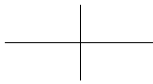
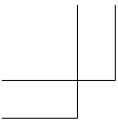

## Setup

- Near fire or heating devices
- Near magnetic fields (such as near microwaves and magnets)
- Areas subject to extreme temperature changes, such as next to air conditioners
- Near devices that emit strong radio waves, such as mobile phones

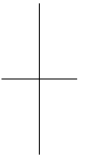
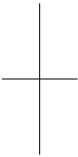

For assistance, please visit <http://shop.panasonic.com/support> 11

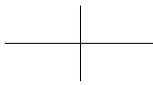
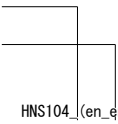

## Setup

### Information about sensor features

The sensor uses a microphone to detect the unique sound frequencies that are produced when glass breaks. Please read the following information before deciding where to install the sensor.

**Note:**

- The sensor's features are not designed to be used in situations that require high reliability. We do not recommend use of the sensor's features in these situations.
- Panasonic takes no responsibility for any injury or damage caused by the use of the sensor.
- The sensor may make false detections when there is noise from metallic blinds opening and closing, metallic bells of alarm clocks, etc.
- The sensor is designed to detect the sound of glass breaking as a result of an impact. It will not detect other types of breaks, such as when glass is cut or removed.
- If the sensor malfunctions, is out of range, or if its battery power is too low, the hub sounds an alert, the hub's indicator flashes, and a message is displayed by the **[Home Network]** app. You can cancel the alert temporarily by pressing the hub's **[Wi-Fi SETUP]** button. When you have remedied the situation (e.g., moved the sensor closer to the hub, replaced the battery, etc.), the alert will not sound again.

### Applicable glass specifications<sup>\*1</sup>

Type	Thickness
Plate	Minimum: 2 mm (1/16 inch) Maximum: 6 mm (1/4 inch)
Tempered	Minimum: 3 mm (1/8 inch) Maximum: 6 mm (1/4 inch)
Insulating <sup>*2</sup>	Minimum: 2 mm (1/16 inch) Maximum: 6 mm (1/4 inch)

<sup>\*1</sup> In compliance with UL 639.

<sup>\*2</sup> Sealed insulating glass types are protected only if both plates of glass are broken.

**Note:**

- Minimum size for all types is 28 cm × 28 cm (11 1/32 inches × 11 1/32 inches).
- The glass must be secured in a frame, and the frame must be installed in a wall.
- The sensor may not detect glass breaks for types of glass not listed here, such as wire-mesh reinforced glass and glass coated with a film.
- Install the sensor in accordance with the Standard for Installation and Classification of Burglar and Holdup Alarm Systems, UL 681.

12 For assistance, please visit <http://shop.panasonic.com/support>

### Sensor detection range

The sensor detection range varies depending on position of the sensitivity switch ([HIGH]/[LOW]).

**Note:**

- Install the sensor in the same room as the window that you want to detect. Walls or other obstacles between the window and the sensor may prevent the sensor from detecting breaking glass, even when the sensor is installed within the ranges listed here.

#### When looking from above

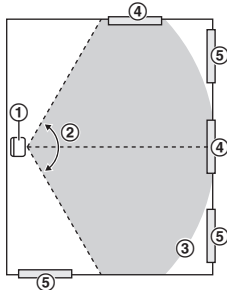

- ① Sensor
- ② Horizontal range: approx. 120°
- ③ Max. distance: approx. 4.6 m (15 feet) when set to **[HIGH]**, or approx. 2.3 m (7.5 feet) when set to **[LOW]**
- ④ Glass inside detectable area
- ⑤ Glass outside detectable area

#### When looking from the side

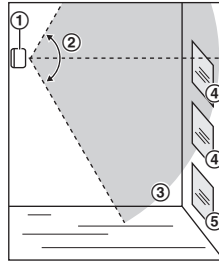

- ① Sensor
- ② Vertical range: approx. 120°
- ③ Max. distance: approx. 4.6 m (15 feet) when set to **[HIGH]**, or approx. 2.3 m (7.5 feet) when set to **[LOW]**
- ④ Glass inside detectable area
- ⑤ Glass outside detectable area

## Setup

### Wall mounting

There are two methods for wall mounting the sensor. To mount the sensor flat against the wall, use the rear cover. To mount the sensor so that it faces 45° to the left or right, use the wall mounting adaptor.

#### Mounting examples\*1 of the rear cover and wall mounting adaptor

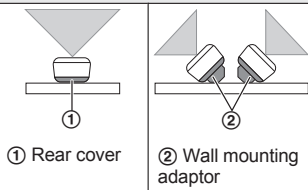

\*1 View of looking from above.

#### Note:

- Mount the sensor on the stable location where the sensor can be adequately supported when mounting.
- Do not mount the sensor on a soft material. It may fall down, break or cause injury.
- Do not mount the sensor on the following places: gypsum board, ALC (autoclaved lightweight cellular concrete), concrete block, plywood less than 25.4 mm (1 inch) thick, etc.
- Install the sensor opposite from the window that you want to monitor for glass breaks. Do not install the sensor on the same wall as the window.
- Install the sensor such that there are no obstacles between the sensor and the window that may block the sound of glass breaking.

- Ambient noise, such as the sound of tableware, glass, or metal objects contacting each other, explosive noises, children's voices, howling of dogs, etc., may cause false detections. False detections may occur when the sensor is armed if it is installed in a kitchen, garage, utility room, stairwell, bathroom, etc.
- Do not install the sensor near an air compressor, as the air pressure generated may cause false detections.
- Do not install the sensor where breezes or wind from a fan may blow on the sensor, as this may cause false detections or prevent the sensor from detecting the sound of glass breaking.

#### Using the rear cover

- 1 Remove the rear cover by pressing the upper sides of the cover (1) and sliding it down (2).

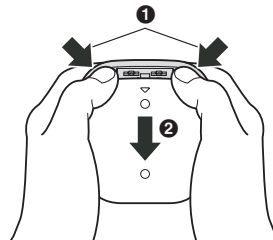

- 2 Attach the rear cover to the wall by using screws (A).
  - Place the rear cover with "UP" mark facing upwards.

14 For assistance, please visit <http://shop.panasonic.com/support>

## Setup

- **B** 37 mm (1 15/32 inches)

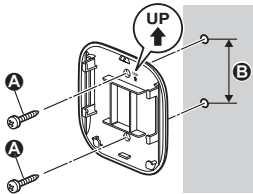

### 3 Attach the sensor to the rear cover.

- Insert the grooves on the sensor to the 4 tabs on the rear cover, and then push down the sensor.

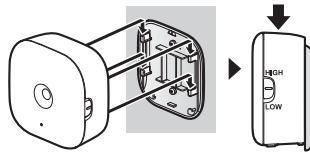

### Using the wall mounting adaptor

- 1 Remove the rear cover by pressing the upper sides of the cover (1) and then sliding it down (2).

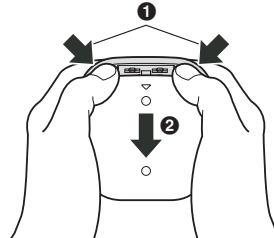

For assistance, please visit <http://shop.panasonic.com/support> 15

## Setup

- 2 Attach the wall mounting adaptor to the wall by using screws (A).
  - Place the wall mounting adaptor with "UP" mark facing upwards.
  - B 21 mm (27/32 inches)

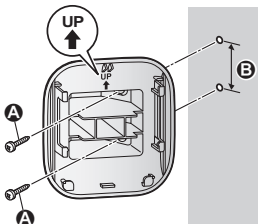

- 3 Attach the sensor to the wall mounting adaptor.
  - Insert the grooves on the sensor to the 4 tabs on the wall mounting adaptor, and then push down the sensor.

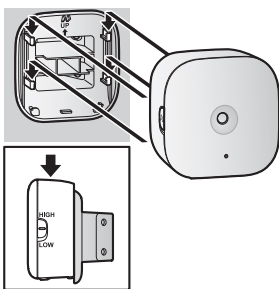

16 For assistance, please visit <http://shop.panasonic.com/support>



## Adjusting the sensor sensitivity

You can use the **[HIGH]/[LOW]** switch (page 8) to adjust the sensor's sensitivity.

Set it to **[LOW]** if the sensor frequently makes false detections.



## Features available when using the [Home Network] app

Some of the sensor's features that are available when using the **[Home Network]** app are listed below. For more information, refer to the User's Guide (page 17).

- **Alarm system**  
You can use the app to arm and disarm the alarm system, confirm the current status of the sensor, and view a log of previous events.
- **Sensor integration**  
You can configure the sensor to trigger other system events, such as camera recording, turning on an electric device (such as a lamp), etc. (Appropriate device required.)
- **Telephone alert**  
You can configure the system to call a preprogrammed phone number when the sensor is triggered.

## Accessing the User's Guide

The User's Guide is a collection of online documentation that helps you get the most out of the **[Home Network]** app.

- 1 **iPhone®/iPad®**  
Tap  in the app's home screen.
- Android™ devices**  
Tap  or press your mobile device's menu button in the app's home screen.
- 2 Tap **[User's Guide]**.

### Note:

- Microsoft® Windows® Internet Explorer® 8 and earlier versions are not supported.
- Android 4.1 or later versions are recommended.
- You can also access the User's Guide at the web page listed below.



[www.panasonic.net/pcc/support/tel/homenetwork/manual/](http://www.panasonic.net/pcc/support/tel/homenetwork/manual/)

For assistance, please visit <http://shop.panasonic.com/support> 17

## Appendix

### Specifications

- **Standards**  
DECT (Digital Enhanced Cordless Telecommunications)
- **Frequency range**  
DECT: 1.92 GHz – 1.93 GHz
- **RF transmission power**  
DECT: 115 mW (max.)
- **Power source**  
AA (LR6) Alkaline battery (2 × 1.5 V)
- **Operating conditions**  
0 °C – 40 °C (32 °F – 104 °F)
- **Detection method**  
Acoustic sensor
- **Sensor detection range**  
Horizontal: approx. ±60°  
Vertical: approx. ±60°  
Distance\*1: approx. 4.6 m (15 feet) when the sensitivity switch is set to **[HIGH]**; approx. 2.3 m (7.5 feet) when set to **[LOW]**
- **Battery life**  
Up to 1 year\*2
- **Dimensions (height × width × depth)**
  - With the rear cover attached:  
Approx. 72 mm × 73 mm × 39 mm (2 27/32 inches × 2 7/8 inches × 1 17/32 inches)
  - With the wall mounting adaptor attached:  
Approx. 72 mm × 73 mm × 61 mm (2 27/32 inches × 2 7/8 inches × 2 13/32 inches)
- **Mass (weight)**
  - With the rear cover attached:  
Approx. 69 g (0.15 lb), excluding the batteries
  - With the wall mounting adaptor attached:  
Approx. 76 g (0.17 lb), excluding the batteries

- \*1 When the surrounding temperature is approx. 25 °C (77 °F).
- \*2 When the sensor is triggered once a month and the surrounding temperature is approx. 25 °C (77 °F). Note that battery life may be reduced in very cold environments, and in areas where loud noises (such as door slams) occur frequently.

18 For assistance, please visit <http://shop.panasonic.com/support>

## FCC and other information

This device complies with Part 15 of the FCC Rules. Operation is subject to the following two conditions:

(1) This device may not cause harmful interference, and (2) this device must accept any interference received, including interference that may cause undesired operation.

Privacy of communications may not be ensured when using this device.

### CAUTION:

Any changes or modifications not expressly approved by the party responsible for compliance could void the user's authority to operate this device.

### NOTE:

This equipment has been tested and found to comply with the limits for a Class B digital device, pursuant to Part 15 of the FCC Rules. These limits are designed to provide reasonable protection against harmful interference in a residential installation. This equipment generates, uses, and can radiate radio frequency energy and, if not installed and used in accordance with the instructions, may cause harmful interference to radio communications. However, there is no guarantee that interference will not occur in a particular installation. If this equipment does cause harmful interference to radio or television reception, which can be determined by turning the equipment off and on, the user is encouraged to try to correct the

interference by one or more of the following measures:

- Reorient or relocate the receiving antenna.
- Increase the separation between the equipment and receiver.
- Connect the equipment into an outlet on a circuit different from that to which the receiver is connected.
- Consult the dealer or an experienced radio/TV technician for help.

Some devices operate at frequencies that may cause interference to nearby TVs and VCRs. To minimize or prevent such interference, this device should not be placed near or on top of a TV or VCR. If interference is experienced, move this device further away from the TV or VCR. This will often reduce or eliminate interference.

### FCC RF Exposure Warning:

- This product complies with FCC radiation exposure limits set forth for an uncontrolled environment.
- To comply with FCC RF exposure requirements, the device must be installed and operated 20 cm (8 inches) or more between the product and all person's body.
- This product may not be collocated or operated in conjunction with any other antenna or transmitter.
- For body-worn operation, the device must be used only with a non-metallic accessory. Use of other accessories may not ensure compliance with FCC RF exposure requirements.

### Notice:

- FCC ID can be found inside the battery compartment.

For assistance, please visit <http://shop.panasonic.com/support> 19

---

---

## Customer services

# **Shop Accessories!**

for all your Panasonic gear

Go to

<http://shop.panasonic.com/support>

Get everything you need to get the most out of  
your Panasonic products

Accessories & Parts for your Camera, Phone, A/V  
products, TV, Computers & Networking, Personal  
Care, Home Appliances, Headphones, Batteries,  
Backup Chargers & more...

## **Customer Services Directory**

For Product Information, Operating Assistance,  
Parts, Owner's Manuals, Dealer and Service info  
go to <http://shop.panasonic.com/support>

You may also contact us directly at: 1-800-272-7033,

Monday - Friday 9 am to 9 pm;

Saturday - Sunday 10 am to 7 pm, EST.

For the hearing or speech impaired TTY: 1- 877-833-8855

As of June 2015

---

20 For assistance, please visit <http://shop.panasonic.com/support>

## Limited Warranty (ONLY FOR U.S.A.)

### Panasonic Products Limited Warranty

#### Limited Warranty Coverage (For USA Only)

If your product does not work properly because of a defect in materials or workmanship, Panasonic Corporation of North America (referred to as "the warrantor") will, for the length of the period indicated on the chart below, which starts with the date of original purchase ("warranty period"), at its option either (a) repair your product with new or refurbished parts, (b) replace it with a new or a refurbished equivalent value product, or (c) refund your purchase price. The decision to repair, replace or refund will be made by the warrantor.

Product or Part Name	Parts	Labor
Home Network System Products	One (1) Year	One (1) Year
microSD card (Included model only)	90 days	N/A

During the "Labor" warranty period there will be no charge for labor. During the "Parts" warranty period, there will be no charge for parts. This Limited Warranty excludes both parts and labor for non-rechargeable batteries, antennas, and cosmetic parts (cabinet). This warranty only applies to products purchased and serviced in the United States. This warranty is extended only to the original purchaser of a new product which was not sold "as is".

#### Mail-In Service--Online Repair Request

#### Online Repair Request

To submit a new repair request and for quick repair status visit our Web Site at <http://shop.panasonic.com/support>

When shipping the unit, carefully pack, include all supplied accessories listed in the Owner's Manual, and send it prepaid, adequately insured and packed well in a carton box. When shipping Lithium Ion batteries please visit our Web Site at <http://shop.panasonic.com/support> as Panasonic is committed to providing the most up to date information. Include a letter detailing the complaint, a return address and provide a daytime phone number where you can be reached. A valid registered receipt is required under the Limited Warranty.

**IF REPAIR IS NEEDED DURING THE WARRANTY PERIOD, THE PURCHASER WILL BE REQUIRED TO FURNISH A SALES RECEIPT/PROOF OF PURCHASE INDICATING DATE OF PURCHASE, AMOUNT PAID AND PLACE OF PURCHASE. CUSTOMER WILL BE CHARGED FOR THE REPAIR OF ANY UNIT RECEIVED WITHOUT SUCH PROOF OF PURCHASE.**

For assistance, please visit <http://shop.panasonic.com/support> 21

## Appendix

---

### **Limited Warranty Limits and Exclusions**

This warranty ONLY COVERS failures due to defects in materials or workmanship, and DOES NOT COVER normal wear and tear or cosmetic damage. The warranty ALSO DOES NOT COVER damages which occurred in shipment, or failures which are caused by products not supplied by the warrantor, or failures which result from accidents, misuse, abuse, neglect, mishandling, misapplication, alteration, faulty installation, set-up adjustments, misadjustment of consumer controls, improper maintenance, power line surge, lightning damage, modification, introduction of sand, humidity or liquids, commercial use such as hotel, office, restaurant, or other business or rental use of the product, or service by anyone other than a Factory Service Center or other Authorized Servicer, or damage that is attributable to acts of God.

**THERE ARE NO EXPRESS WARRANTIES EXCEPT AS LISTED UNDER "LIMITED WARRANTY COVERAGE".**

**THE WARRANTOR IS NOT LIABLE FOR INCIDENTAL OR CONSEQUENTIAL DAMAGES RESULTING FROM THE USE OF THIS PRODUCT, OR ARISING OUT OF ANY BREACH OF THIS WARRANTY.**

(As examples, this excludes damages for lost time, travel to and from the servicer, loss of or damage to media or images, data or other memory or recorded content.

The items listed are not exclusive, but for illustration only.)

**ALL EXPRESS AND IMPLIED WARRANTIES, INCLUDING THE WARRANTY OF MERCHANTABILITY, ARE LIMITED TO THE PERIOD OF THE LIMITED WARRANTY.**

Some states do not allow the exclusion or limitation of incidental or consequential damages, or limitations on how long an implied warranty lasts, so the exclusions may not apply to you. This warranty gives you specific legal rights and you may also have other rights which vary from state to state. If a problem with this product develops during or after the warranty period, you may contact your dealer or Service Center. If the problem is not handled to your satisfaction, then write to:

Consumer Affairs Department  
Panasonic Corporation of North America  
661 Independence Pkwy  
Chesapeake, VA 23320

**PARTS AND SERVICE, WHICH ARE NOT COVERED BY THIS LIMITED WARRANTY, ARE YOUR RESPONSIBILITY.**

As of June 2015

---

22 For assistance, please visit <http://shop.panasonic.com/support>

# IMPORTANT!

If your product is not working properly. . .

- ① **Use alkaline batteries.**  
(Rechargeable Ni-MH batteries CANNOT be used.)
- ② Use the **Home Network app** to access the **User's Guide** and refer to the **Troubleshooting** section.



Visit our Web site: <http://shop.panasonic.com/support>  
•FAQ and troubleshooting hints are available.

## For your future reference

We recommend keeping a record of the following information to assist with any repair under warranty.

Serial No.	Date of purchase
------------	------------------

(found inside the battery compartment) Name and address of dealer
--

Attach your purchase receipt here.
------------------------------------

Panasonic Corporation of North America

Two Riverfront Plaza, Newark, NJ 07102-5490

© Panasonic System Networks Co., Ltd. 2015

# Panasonic®

## Guía de instalación

### Sistema de red doméstico Sensor de rotura de cristales

Modelo n° **KX-HNS104**



#### Gracias por adquirir un producto Panasonic.

Este documento explica cómo instalar el sensor de rotura de vidrio de forma correcta. Para obtener detalles sobre cómo usar el sistema, consulte la Guía del usuario (página 12).

Lea este documento antes de usar la unidad, y guárdelo para consultarlo en el futuro.

Para obtener ayuda, comuníquese con nosotros llamando al 1-800-272-7033 o visite nuestro sitio web: <http://shop.panasonic.com/support> para clientes en los EE. UU. (solo en inglés)

**Por favor, registre su producto: <http://shop.panasonic.com/support>**

Para utilizar este dispositivo:

- Descargue la versión más reciente de la aplicación [**Home Network**].
- Actualice el hub a la versión de firmware más reciente (versión 5.55 o posterior). Para obtener más información, consulte la Guía del usuario (página 12).



\*PNQX7270XA\*

**PNQX7270XA** CC0815WK2095 (E)





## ***Tabla de Contenido***



---

### **Configuración**

Nombres de los componentes y funciones .....	3
Led indicador .....	3
Resumen de configuración .....	3
Colocación de las baterías .....	4
Registro del sensor .....	5
Confirmación del área de uso .....	6
Información acerca de las características del sensor .....	7
Montaje en la pared .....	9

### **Apéndice**

Ajuste de sensibilidad del sensor .....	12
Acceso a la Guía del usuario .....	12



## Configuración

### Nombres de los componentes y funciones

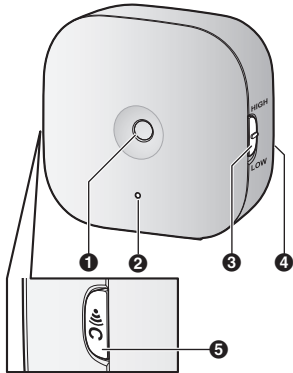

- 1 Micrófono
- 2 Led indicador
- 3 [HIGH]/[LOW]  
Se usa para cambiar la sensibilidad del sensor (página 12).
- 4 Tapa posterior
- 5 [●]C  
Se usa para confirmar el estado del sensor o para registrar el sensor en el hub.

### Led indicador

Puede oprimir [●]C y verificar el Led indicador para confirmar el estado del sensor. Tras confirmar el estado del sensor, recomendamos apagar el led indicador volviendo a pulsar [●]C lo antes posible,

ya que de lo contrario la vida útil de la batería podría reducirse.

Indicador	Estado
Verde, encendido	No se detectó ninguna rotura de vidrio
Rojo, encendido	Se detectó una rotura de vidrio
Rojo, parpadeante	El sensor está fuera de alcance del hub
Verde, parpadeando lentamente	Modo de registro (Oprimió y mantuvo oprimido [●]C)
Apagado	Sin batería

#### Nota:

- El Led indicador no indica el estado del sensor si el sensor no se ha registrado (página 5).

## Resumen de configuración

- 1 **Configuración inicial**  
Asegúrese de poder acceder al sistema mediante su dispositivo móvil. Para obtener más detalles, consulte la Guía de configuración del sistema que viene con su hub.
- 2 **Inserte las baterías**  
El sensor usa batería.
- 3 **Registro**  
Solo se requiere si se compró el sensor por separado (es decir, no como parte de un paquete).
- 4 **Confirme el área de instalación**  
Lea la información de este documento para confirmar que el área de instalación deseada sea la adecuada para el correcto funcionamiento.

Para obtener ayuda, visite <http://shop.panasonic.com/support> 3

## Configuración

- 5 Instalación**  
Instale el sensor en la ubicación deseada.

## Colocación de las baterías

- SOLO USE baterías alcalinas AA (LR6).
- NO use baterías de manganeso/Ni-Cd/Ni-MH.
- Verifique las polaridades ( $\oplus$ ,  $\ominus$ ).

- 1** Extraiga la tapa posterior ejerciendo presión sobre los lados superiores de la misma **(1)** y deslícela hacia abajo **(2)**.

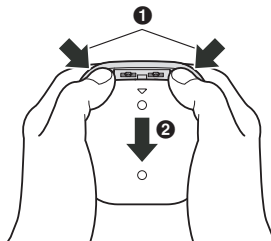

- 2** Inserte las baterías.

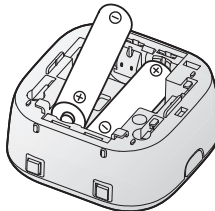

- 4** Para obtener ayuda, visite <http://shop.panasonic.com/support>

## Configuración

- 3 Coloque la tapa posterior.
- Colóquela con la marca "▽" hacia arriba y deslícela.

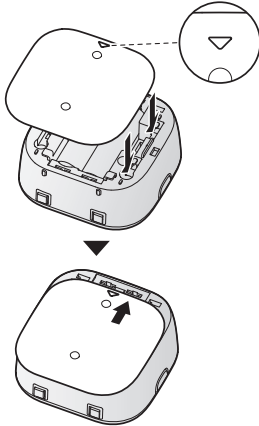

### Nota:

- Si la carga de la batería del sensor está baja, aparecerá un mensaje en la pantalla [Sensor] de la aplicación [Home Network]. Se recomienda verificar esta pantalla de forma periódica para asegurarse de que la batería no se descargue completamente. Para obtener más información, consulte la Guía del usuario (página 12).

## Registro del sensor

Este procedimiento no es necesario para unidades que son parte de un paquete.

Antes de poder usar el sensor, debe registrarlo en el hub.

Si compró los dispositivos por separado (es decir, no como parte de un paquete), debe registrar cada dispositivo en el hub.

Puede registrar cada unidad mediante los botones de registro o la aplicación [Home Network].

### Nota:

- Para obtener información acerca de cómo eliminar dispositivos del registro, consulte la Guía del usuario (página 12).

## Uso de los botones de registro

- Hub:**  
Oprima y mantenga oprimido **[•]C** [OTHER DEVICE] hasta que el Led indicador parpadee lentamente en verde.
- Sensor:**  
Oprima y mantenga oprimido **[•]C** hasta que el Led indicador parpadee lentamente en verde (página 3).
  - Cuando se ha completado el registro, el hub emitirá un pitido largo.

### Nota:

- Para cancelar sin registrar el sensor, oprima **[•]C** en el hub y en el sensor nuevamente.
- Si el registro falla, el hub emitirá varios pitidos cortos.

## Uso de la aplicación

Cuando registra el sensor con la aplicación [Home Network], puede asignarle un nombre a sus dispositivos y agruparlos por ubicación. Para obtener más información, consulte la Guía del usuario (página 12).

Para obtener ayuda, visite <http://shop.panasonic.com/support> 5

## Configuración

### Confirmación del área de uso

#### Alcance de la comunicación inalámbrica

El alcance de la comunicación inalámbrica de cada dispositivo en el sistema del hub es de aproximadamente 50 m (160 pies) en interiores y de aproximadamente 300 m (1,000 pies) en el exterior. Es posible que la comunicación inalámbrica no sea tan confiable cuando se encuentran los obstáculos siguientes entre el hub y otros dispositivos.

- Puertas o pantallas metálicas
- Paredes que contengan aislamiento de aluminio
- Paredes de hormigón o hierro corrugado
- Ventanas de vidrio doble
- Varias paredes
- Cuando los dispositivos están en pisos o edificios diferentes

#### Nota:

- Puede verificar el estado de la comunicación del sensor presionando **[•)C]**. Si el Led indicador está iluminado en verde o rojo, el sensor se está comunicando de forma adecuada con el hub. Si el Led indicador parpadea en rojo, se encuentra fuera de alcance del hub.

#### Precauciones respecto al área de uso

El uso del sensor en las siguientes áreas puede causar deformación, averías o fallas de operación.

- A la luz del sol
- En áreas expuestas a grasa o vapor, como en cocinas

- Cerca del fuego o calefactores
- Cerca de campos magnéticos (como cerca de hornos microondas e imanes)
- Áreas sujetas a cambios extremos de temperatura, como cerca de aires acondicionados
- Cerca de dispositivos que emiten ondas de radio potentes, como teléfonos móviles

6 Para obtener ayuda, visite <http://shop.panasonic.com/support>

### Información acerca de las características del sensor

El sensor usa un micrófono para detectar las frecuencias de sonido únicas que se producen cuando se rompe el vidrio. Lea la información siguiente antes de decidir dónde instalar el sensor.

**Nota:**

- Las características del sensor no están diseñadas para utilizarse en situaciones que requieran alta confiabilidad. No recomendamos el uso de las características del sensor en esas situaciones.
- Panasonic no asume ninguna responsabilidad por lesiones o daños provocados por el uso del sensor.
- Es posible que el sensor realice falsas detecciones debido al sonido de apertura o cierre de persianas metálicas o al sonido metálico de la alarma de un reloj, etc.
- El sensor está diseñado para detectar el sonido del vidrio que se rompe como consecuencia de un impacto. No detectará otro tipo de roturas, como cuando se corta o extrae el vidrio.
- Si el sensor funciona de forma incorrecta o está fuera de rango, o si tiene poca batería, el hub emite una alerta y hace brillar el indicador y, además, la aplicación **[Home Network]** muestra un mensaje. Puede cancelar temporalmente la alerta al omitir el botón **[Wi-Fi SETUP]** del hub. Cuando haya normalizado la situación (por ejemplo, movió el sensor más cerca del hub, reemplazó la batería, etc.), la alerta no volverá a sonar.

### Especificaciones del vidrio\*1

Tipo	Grosor
Plano	Mínimo: 2 mm (1/16 pulgadas) Máximo: 6 mm (1/4 pulgadas)
Templado	Mínimo: 3 mm (1/8 pulgadas) Máximo: 6 mm (1/4 pulgadas)
Aislante*2	Mínimo: 2 mm (1/16 pulgadas) Máximo: 6 mm (1/4 pulgadas)

\*1 Cumple con la norma UL 639.

\*2 Los tipos de vidrios aislantes sellados se protegen solo si se rompen ambas placas del vidrio.

**Nota:**

- El tamaño mínimo para todos los tipos es 28 cm × 28 cm (11 1/32 pulgadas × 11 1/32 pulgadas).
- El vidrio debe estar fijado en un marco, y el marco debe estar instalado en una pared.
- Es posible que el sensor no detecte roturas en otros tipos de vidrio que no se enumeren aquí, como los vidrios reforzados con una malla metálica o recubiertos con una película.
- Instale el sensor de acuerdo con la Norma para la Instalación y Clasificación de Sistemas de Alarma contra Robos y Asaltos (Standard for Installation and Classification of Burglar and Holdup Alarm Systems), UL 681.

Para obtener ayuda, visite <http://shop.panasonic.com/support> 7

## Configuración

### Alcance de detección del sensor

El rango de detección del sensor varía según la posición del interruptor de sensibilidad (**[HIGH]**/**[LOW]**).

#### Nota:

- Instale el sensor en la misma habitación donde se encuentra la ventana que desea monitorear. Las paredes u otros obstáculos entre la ventana y el sensor pueden impedir que el sensor detecte rotura de vidrio, incluso cuando el sensor está instalado dentro de los rangos que aquí se detallan.

#### Vista desde arriba

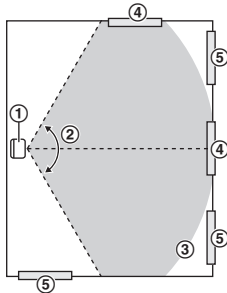

- ① Sensor
- ② Alcance horizontal: aprox. 120°
- ③ Distancia máx.: aprox. 4.6 m (15 pies) cuando se establece en **[HIGH]**, o aprox. 2.3 m (7.5 pies) cuando se establece en **[LOW]**
- ④ Vidrio dentro del área detectable
- ⑤ Vidrio fuera del área detectable

#### Vista lateral

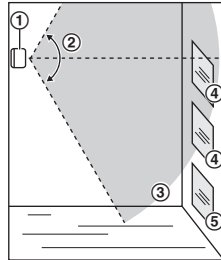

- ① Sensor
- ② Alcance vertical: aprox. 120°
- ③ Distancia máx.: aprox. 4.6 m (15 pies) cuando se establece en **[HIGH]**, o aprox. 2.3 m (7.5 pies) cuando se establece en **[LOW]**
- ④ Vidrio dentro del área detectable
- ⑤ Vidrio fuera del área detectable

8 Para obtener ayuda, visite <http://shop.panasonic.com/support>

## Configuración

### Montaje en la pared

Hay dos métodos para instalar el sensor en la pared. Para montar el sensor contra la pared, utilice la tapa posterior. Para montar el sensor y éste gire 45° a la derecha o a la izquierda, utilice el adaptador de instalación en pared.

#### Ejemplos de instalación\*1 de la tapa posterior y del adaptador de instalación en pared

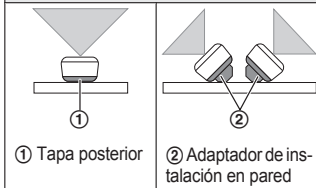

\*1 Vista desde arriba.

#### Nota:

- Monte el sensor en una ubicación estable donde se pueda sostener correctamente.
- No coloque el sensor sobre un material blando. Podría caerse, romperse o provocar lesiones.
- No monte el sensor en las siguientes ubicaciones: tablas de yeso, hormigón celular, bloques de hormigón, contrachapados con grosor inferior a 25.4 mm (1 pulgada), etc.
- Instale el sensor del lado opuesto a la ventana que desea monitorear para detectar roturas de vidrio. No instale el sensor en la misma pared que la ventana.
- Instale el sensor de modo que no queden obstáculos entre el sensor y la ventana que puedan bloquear el sonido de la rotura del vidrio.

- El ruido ambiente, como el sonido de la vajilla u objetos de vidrio o metal que están en contacto, los ruidos explosivos, las voces de niños o los aullidos de perro, entre otros, pueden ocasionar detecciones falsas. Las detecciones falsas pueden producirse cuando el sensor se activa si se instala en una cocina, garage, lavadero, caja de la escalera, baño, etc.
- No instale el sensor cerca de un compresor de aire, ya que la presión de aire generada puede ocasionar detecciones falsas.
- No instale el sensor en lugares donde la brisa o el viento de un ventilador lleguen al sensor, ya que esto puede provocar detecciones falsas o impedir que el sensor detecte el sonido de la rotura de un vidrio.

#### Uso de la tapa posterior

- 1 Extraiga la tapa posterior ejerciendo presión sobre los lados superiores de la misma (1) y deslícela hacia abajo (2).

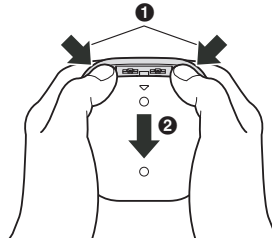

- 2 Instale la tapa posterior en la pared con tornillos (A).
  - Coloque la tapa posterior con la marca "UP" hacia arriba.

Para obtener ayuda, visite <http://shop.panasonic.com/support> 9



## Configuración

- **B** 37 mm (1 15/32 pulgadas)

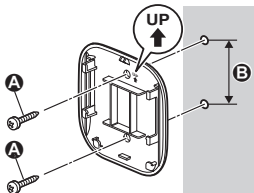

### 3 Coloque el sensor en la tapa posterior.

- Inserte las 4 lengüetas de la tapa posterior en los canales del sensor y luego ejerza presión hacia abajo sobre el sensor.

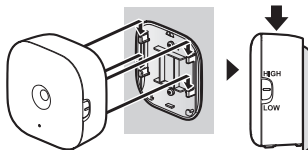

### Uso del adaptador de instalación en pared

- 1 Extraiga la tapa posterior ejerciendo presión sobre los lados superiores de la misma **(1)** y deslícela hacia abajo **(2)**.

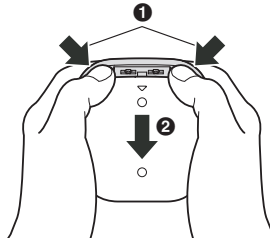

10 Para obtener ayuda, visite <http://shop.panasonic.com/support>

## Configuración

- 2 Instale el adaptador de instalación en pared con tornillos (A).
  - Coloque el adaptador de instalación en pared con la marca "UP" hacia arriba.
  - B 21 mm (27/32 pulgadas)

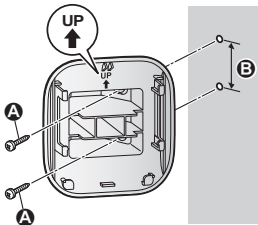

- 3 Coloque el sensor en el adaptador de instalación en pared.
  - Inserte las lengüetas del sensor en los 4 canales del adaptador de instalación en pared y luego ejerza presión hacia abajo sobre el sensor.

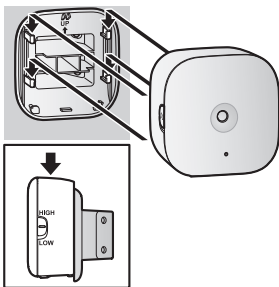

Para obtener ayuda, visite <http://shop.panasonic.com/support> 11

## Apéndice

### Ajuste de sensibilidad del sensor

Puede usar el interruptor **[HIGH]/[LOW]** (página 3) para ajustar la sensibilidad del sensor.

Configúrelo en **[LOW]** si el sensor realiza detecciones falsas frecuentemente.

### Acceso a la Guía del usuario

La Guía del usuario es una colección de documentación en línea que lo ayuda a aprovechar al máximo la aplicación **[Home Network]**.

#### 1 iPhone®/iPad®

Toque  en la pantalla de inicio de la aplicación.

#### Dispositivos Android™

Toque  u oprima el botón menú de su dispositivo en la pantalla de inicio de la aplicación.

#### 2 Toque **[Guía del Usuario]**.

#### Nota:

- No se admite Microsoft® Windows® Internet Explorer® 8 y versiones anteriores.
- Se recomienda Android 4.1 y versiones posteriores.
- También puede acceder a la Guía del usuario mediante la página web a continuación.



[www.panasonic.net/pcc/support/tel/homenetwork/manual/](http://www.panasonic.net/pcc/support/tel/homenetwork/manual/)

12 Para obtener ayuda, visite <http://shop.panasonic.com/support>

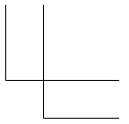
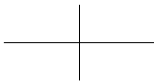
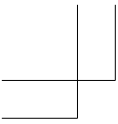

**Notas**

---

