

Panasonic®

Model No. **KX-TG1061**
KX-TG1062
KX-TG1063

Quick Guide

Setting up

Base unit

- Use only the supplied Panasonic AC adaptor PQLV219.

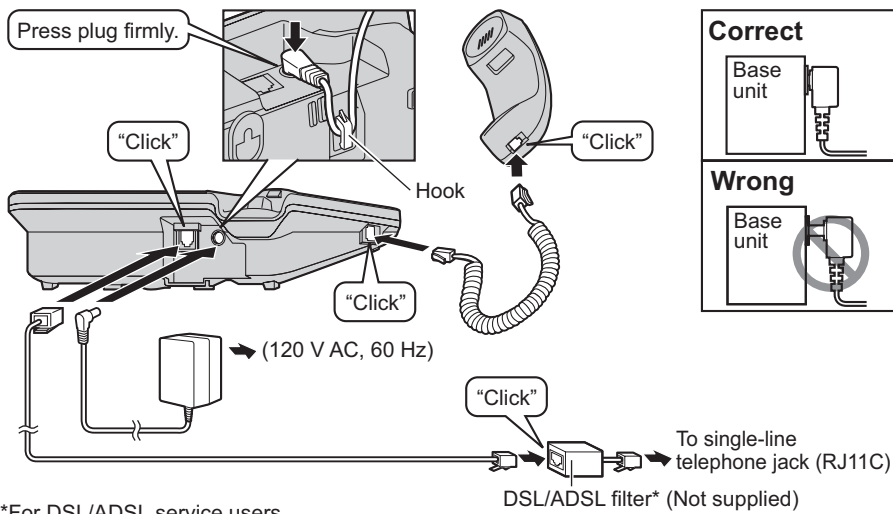

Correct

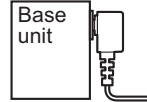

Wrong



Handset

- USE ONLY Ni-MH batteries AAA (R03) size.
- Do NOT use Alkaline/Manganese/Ni-Cd batteries.
- Confirm correct polarities (+, -).

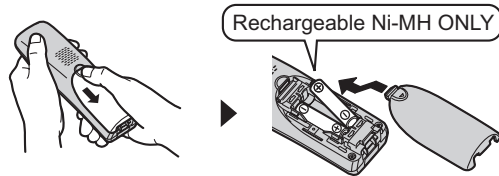

CHARGE FOR ABOUT 7 HOURS

Confirm "Charging" is displayed.



Charger

- Use only the supplied Panasonic AC adaptor PQLV219.

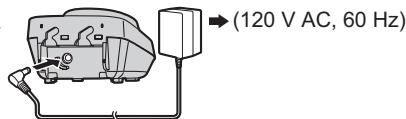

Operating tips

Navigator key/Volume key (VOL.,)

- Scrolling through lists or items
By pressing this key ([▲] or [▼]) repeatedly, you can scroll through (up or down) various lists or items.
- Adjusting the volume
By pressing this key ([▲] or [▼]) repeatedly, you can adjust the receiver or speaker volume (up or down) while talking.
- Moving the cursor
Base unit: [▲], [▼], [◀], or [▶]
Handset: [▲] or [▼]
By pressing the above keys repeatedly, you can move the cursor to edit a number or name.

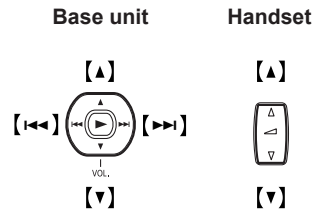

Soft keys

Each unit features 3 soft keys. By pressing a soft key, you can select the feature shown directly above it on the display. [MENU], [REDIAL], and other additional functions are assigned to the soft keys. Pay attention to the display to see what functions the soft keys are assigned during operation.

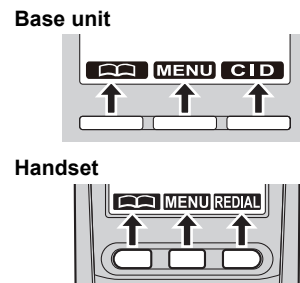

Date and time (Handset)

- 1 [MENU] → [≡][1][0][1]
- 2 Enter the current month, date, and year. → [OK]
- 3 Enter the current hour and minute (12-hour clock format).
- 4 [AM/PM]: Select "AM" or "PM". → [SAVE] → [OFF]

For further information, visit <http://www.panasonic.com/help> or refer to operating instructions.

Basic operations	
Making/Answering calls (Base unit/Handset)	
Making calls	Base unit: Dial the phone number. → Lift the corded handset, or press [SP-PHONE] . Handset: Dial the phone number. → [📞]/[📞]
Answering calls	Base unit: Lift the corded handset, or press [SP-PHONE] . Handset: [📞]/[📞]
To hang up	Base unit: Place the corded handset on the cradle. When the speakerphone is used, press [SP-PHONE] . Handset: [OFF]
To adjust the receiver or speaker volume	Press [▲] or [▼] repeatedly while talking.
Making a call using the redial list	1 [RECALL] → [▼]/[▲]: Select the desired phone number. 2 Proceed with the operation for your unit. Base unit: Lift the corded handset. Handset: [📞]
To adjust the ringer volume	1 [MENU] → [🔊][1][6][0] 2 [▼]/[▲]: Select the desired volume. → [SAVE] 3 Proceed with the operation for your unit. Base unit: [■] Handset: [OFF]
Phonebook (Base unit/Handset)	
Adding entries	1 [📞] → [ADD] 2 Enter the party's name (16 characters max.). → [OK] 3 Enter the party's phone number (24 digits max.). → [OK] 4 [▼]/[▲]: Select the desired group. → [SELECT] 2 times 5 Proceed with the operation for your unit. Base unit: [■] Handset: [OFF] • To enter a name, see the character table in the operating instructions.
Making calls	1 [📞] → [▼]/[▲]: Select the desired entry. 2 Proceed with the operation for your unit. Base unit: Lift the corded handset. Handset: [📞]
Answering system (Base unit)	
Answering on/off	Press [ANSWER ON] to turn on/off the answering system.
Listening to messages	[▶]

For further information, visit <http://www.panasonic.com/help> or refer to operating instructions.

Frequently asked questions	
Question	Cause/solution
Why is ∇ flashing?	<ul style="list-style-type: none"> • The handset is too far from the base unit. Move closer. • The base unit's AC adaptor is not properly connected. Reconnect AC adaptor to the base unit. • You are using the base unit or handset in an area with high electrical interference. Re-position the base unit and use the handset away from sources of interference. • The handset is not registered to the base unit. Register it.
How can I increase the handset volume level?	<ul style="list-style-type: none"> • Press the navigator key [▲] repeatedly while talking.
Why is the conversation noisy or cutting off?	<ul style="list-style-type: none"> • Try to relocate the base unit so that the distance to the handset is minimized. • If the same problem occurs even if the handset is next to the base unit, call Panasonic customer support at 1-800-211-PANA (1-800-211-7262).
Can I add another accessory handset to my base unit?	<ul style="list-style-type: none"> • Yes, you can add up to 6 handsets (including the handset(s) sold with your base unit) to a single base unit. • To purchase additional accessory handset(s) (KX-TGA106), please visit http://www.panasonic.com or call 1-800-332-5368. TTY users (hearing or speech impaired users) can call 1-866-605-1277.
Can I keep the batteries charging all the time?	<ul style="list-style-type: none"> • You can leave the handset on the charger anytime. This will not harm the batteries.
How can I answer a call waiting call (2nd call)?	<ul style="list-style-type: none"> • Press [CALL WAIT] when you hear the call waiting tone.

For further information, visit <http://www.panasonic.com/help> or refer to operating instructions.

Quick troubleshooting

1 Cordless handset shows:

"No link. Reconnect base AC adaptor."

Move closer to the base unit. Unplug, then plug the AC adaptor properly to the base unit and AC outlet.

"No link. Reconnect base AC adaptor." is still displayed.

Remove the batteries for 10 seconds from the handset, and then insert the batteries into the handset again.

"No link. Reconnect base AC adaptor." is still displayed.

Try to re-register the handset (page 7).

Re-registration failed.

Your telephone may need service.
Please visit <http://www.panasonic.com/help> for further troubleshooting.

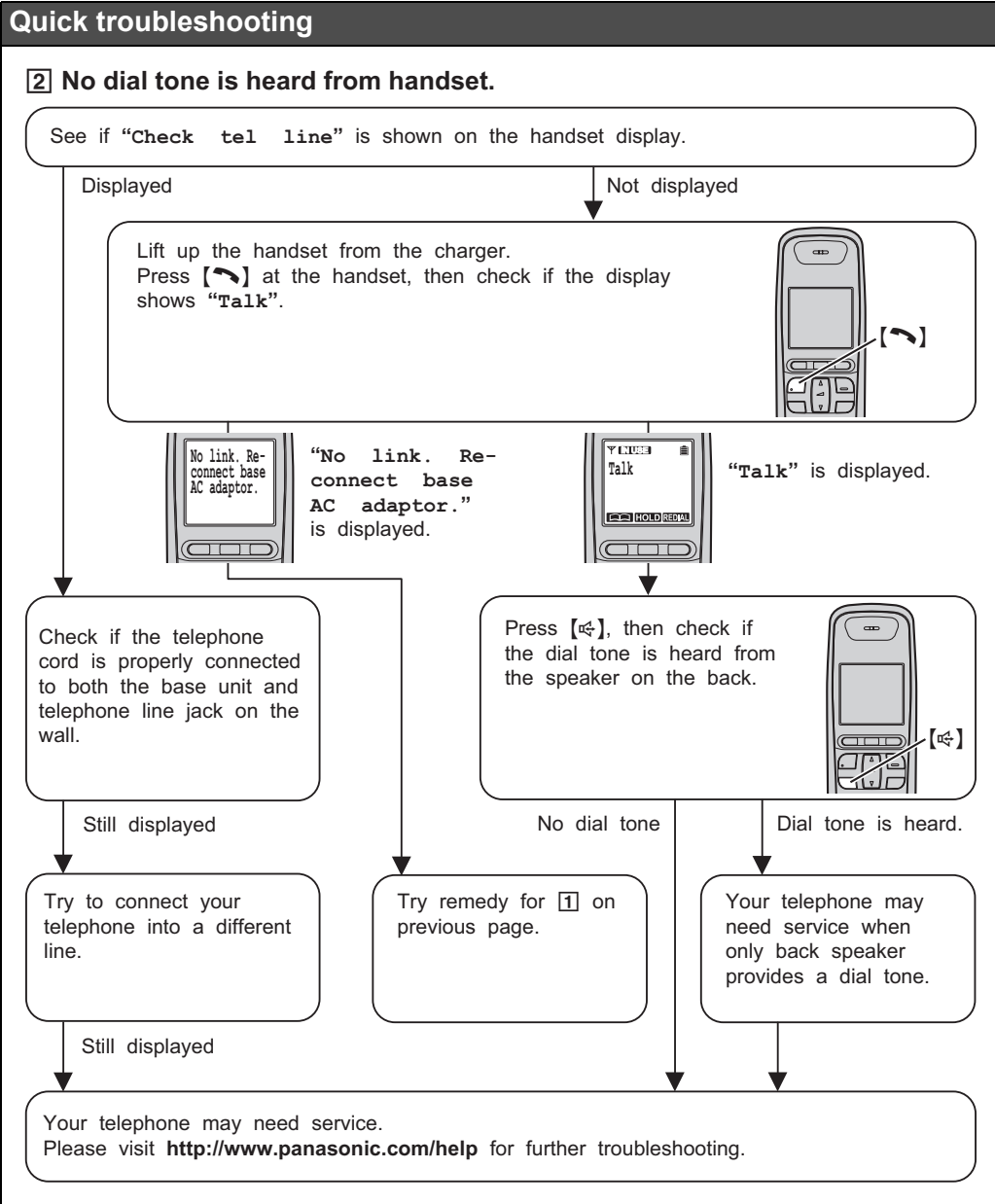

Registering a handset to the base unit

The supplied handset and base unit are pre-registered. If for some reason the handset is not registered to the base unit, re-register the handset.

Handset

[MENU] → [#][1][3][0]

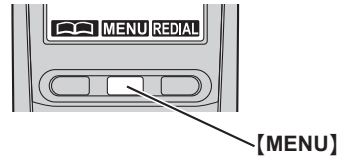

Base unit

Press and hold [LOCATOR] for about 5 seconds until the registration tone sounds.

- The next step must be completed within 90 seconds.

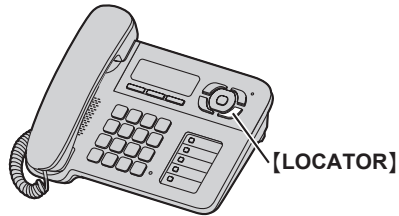

Handset

Press [OK], then wait until a long beep sounds.

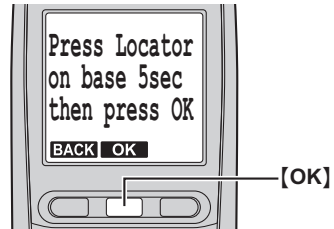

For further registration information, visit
<http://www.panasonic.com/RegisterYourHandset>

IMPORTANT!

If your product is not working properly ...

① Reconnect AC adaptor to the base unit.



② Check if telephone line cord is connected.



③ Use rechargeable Ni-MH batteries.
(Alkaline/Manganese/Ni-Cd batteries CANNOT be used.)



④ Read FAQ in this Quick Guide and troubleshooting page in the Operating Instructions.



Visit our web site: <http://www.panasonic.com/help>
• Operating Instructions downloading, FAQ, and troubleshooting hints are available.



Contact us via the web at:
<http://www.panasonic.com/contactinfo>



Call us at: **1-800-211-PANA (1-800-211-7262)**
• Monday- Friday 9:00am - 9:00pm (EST)
Saturday/Sunday 10:00am - 7:00pm (EST)

To order replacement batteries,
please call: 1-800-332-5368
Or visit: <http://www.panasonic.com/batterystore>