

Panasonic

Quick Start Guide Home Theater Audio System

Model No. SC-HTB70
SC-HTB65

Connections

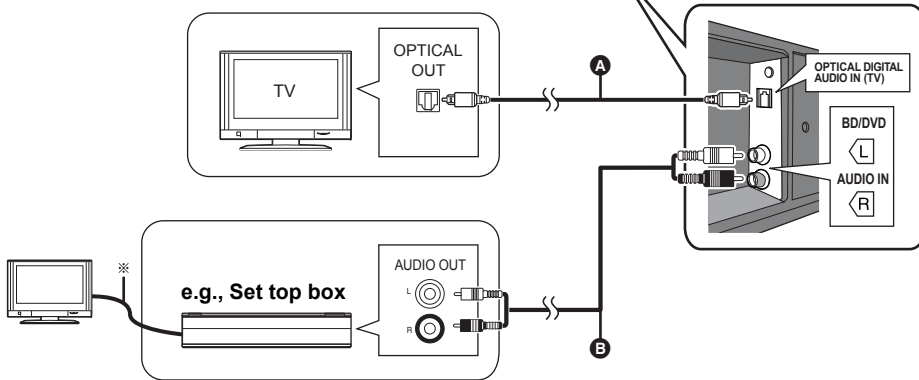

A Optical digital audio cable

B Audio cable

※ Refer to the operating instructions of the respective devices for the optimal connection.

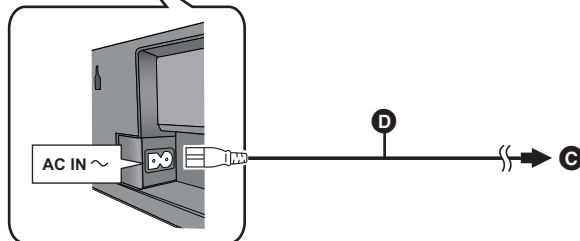

C To a household AC outlet

D AC power supply cord

Using this system

Using with a TV

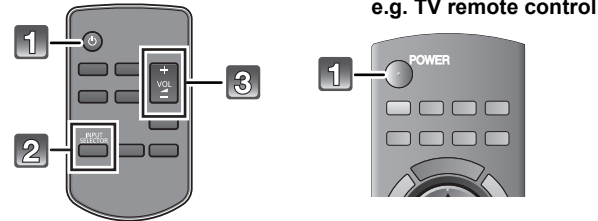

- 1** Turn on the main unit and the TV.
- 2** Press [INPUT SELECTOR] to select the TV sound.
- 3** Press [+ VOL -] to adjust the volume.

• If there is sound from the TV's speakers too, then use the TV's remote control to lower the volume to minimum.

Using with a Bluetooth® device

Preparation

- Turn on the Bluetooth® feature of the device and place the device near the main unit.

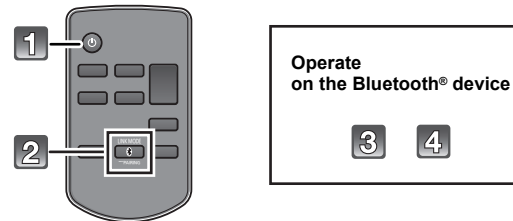

On this system

On the Bluetooth® device

- | | |
|--|--|
| <ol style="list-style-type: none"> 1 Turn on the main unit. 2 Press [G]. | <ol style="list-style-type: none"> 3 Select "SC-HTB70" or "SC-HTB65" from the Bluetooth® device's Bluetooth® menu. 4 Start the playback. |
|--|--|

For installation instructions and other details, be sure to refer to the Owner's Manual.

If you have any questions, contact:

U.S.A. and Puerto Rico: 1-800-211-PANA (7262)
 Mon-Fri: 9 am–9 pm (EST) Lunes-Viernes
 Sat-Sun: 10 am–7 pm (EST) Sabado-Domingo
www.Panasonic.com/help

Canada:
 Telephone: 1-800-561-5505
 E-mail link: "Support → contact us → email" on www.panasonic.ca